

Vane Pumps

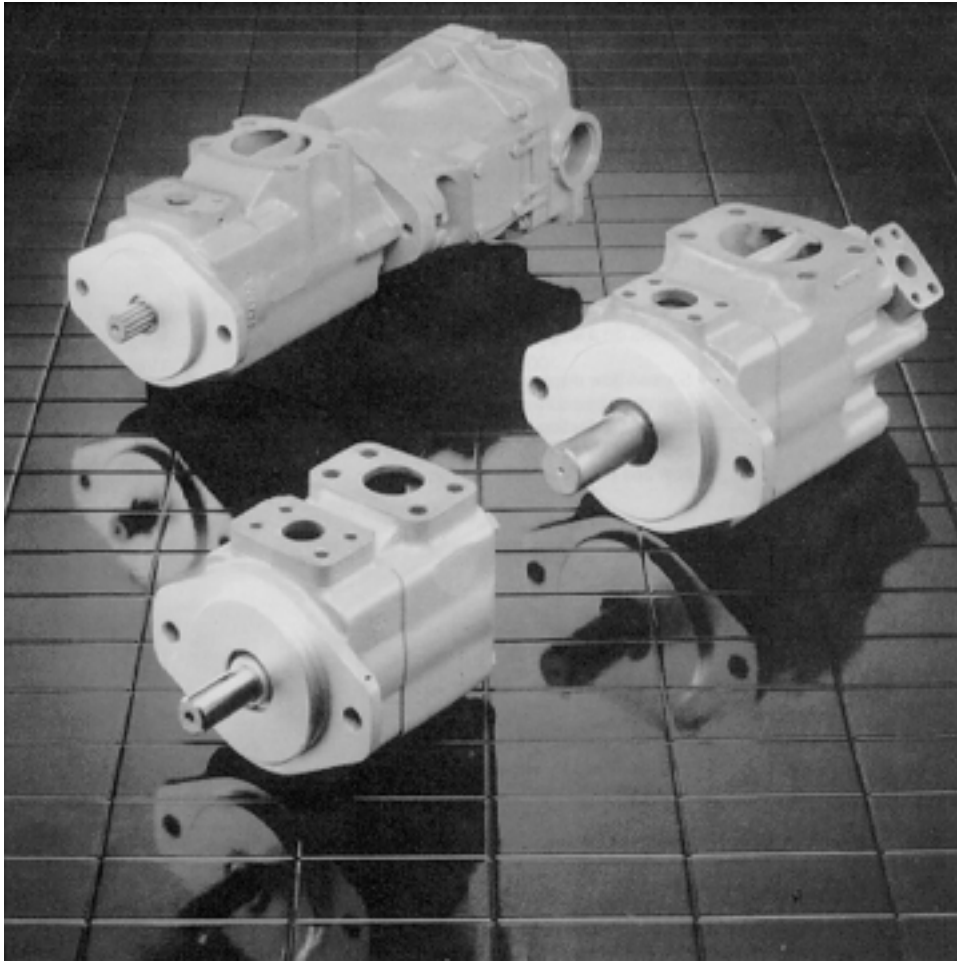

Vane Type Double Pumps

Small Series V, VK, VS, VSK-108, 109, 110-* -10



-10 Design

WARNING:
Use this drawing for parts information only.

Pump Letter	Cap. GPM	Bushing		Pin	Rotor	Vane Kit (12 Vanes)	Ring	Bushing		Cart. Kit (2 Req'd)
		R.H. or L.H.	R.H. or L.H.					R.H. or L.H.	R.H. or L.H.	
These parts are included in cartridge kits										
Y	1.8	2016	2015	2020	2008	912021	12220	2015	2016	912017
E	2.7									912015
G	3.7									912016
A	5.3									912013
C	8.2									912014
D	11.5				2007	912022	2014			912018

Pump Letter	Head
A,C,E,G,Y	24064
D	21608

Pump Letter	Head
A,C,E,G,Y	2303
D	2304

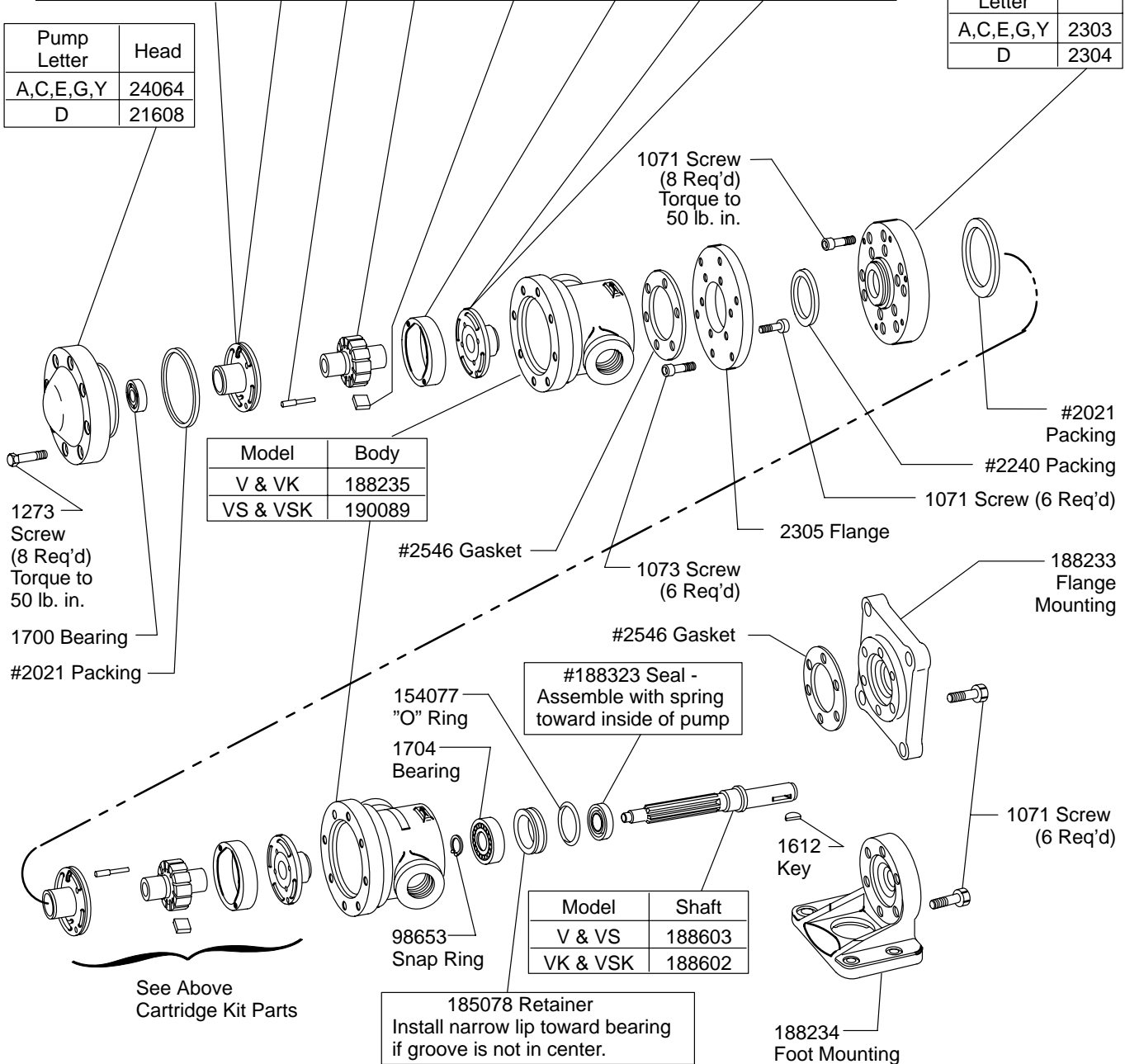

Included in 919049 seal kit

F3 Equivalent 919300 seal kit

Basic Design

See Overhaul Manual
I-3100-S for
Maintenance Information.

Pump Letter	Cap. GPM	Bushing R.H. or L.H.	Pin	Rotor	Vane Kit (12 Vanes)	Ring	Bushing R.H. or L.H.	Cart. Kit (2 Req'd)
These parts are included in cartridge kits								
Y	1.8					12220		912017
E	2.7					2299		912015
G	3.7					40151		912016
A	5.3	2016	2015	2020	2008	912021	2015	2016
C	8.2							
D	11.5				2007	912022		912014 912018

Pump Letter	Head
A,C,E,G,Y	24064
D	21608

Pump Letter	Head
A,C,E,G,Y	2303
D	2304

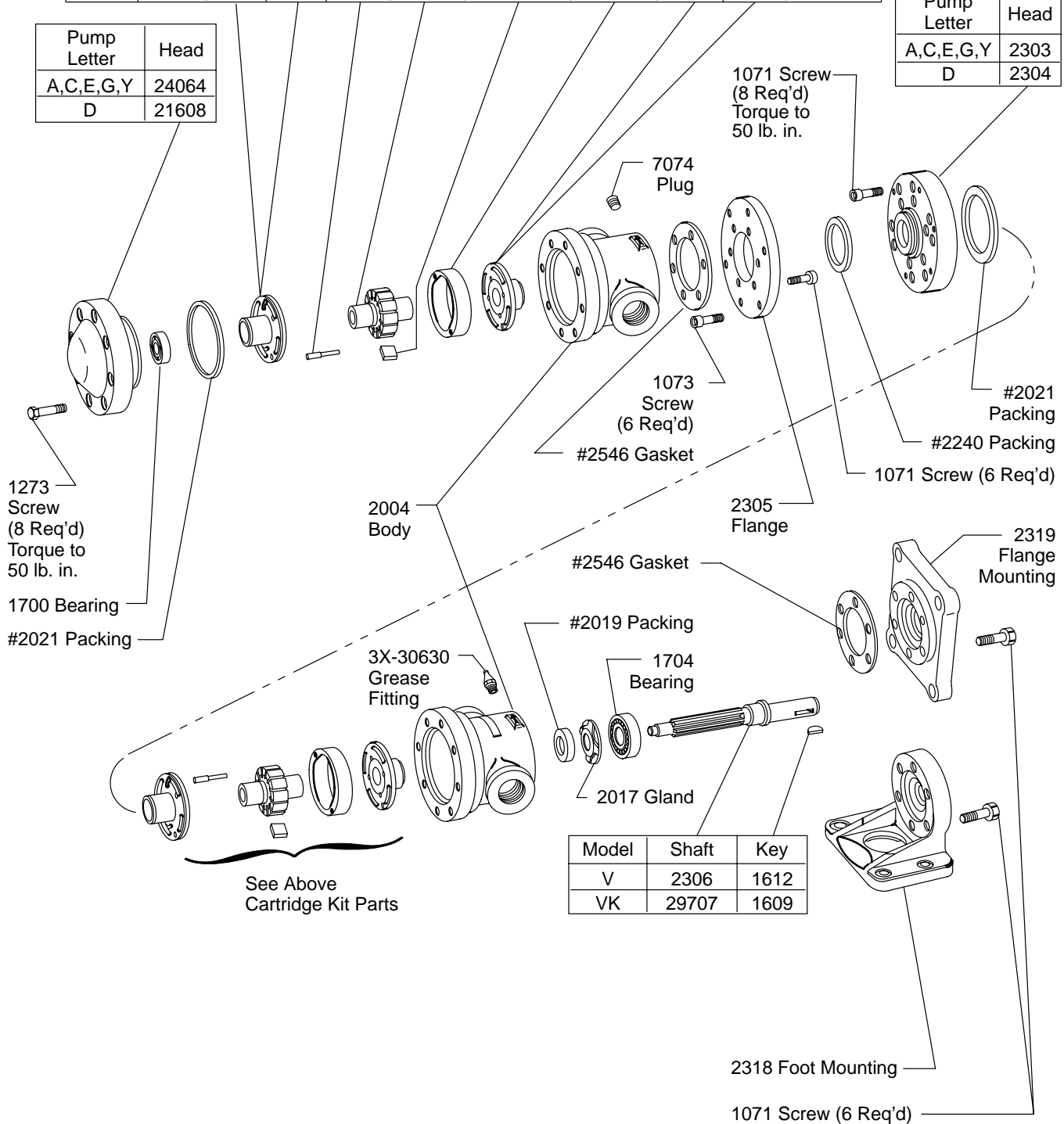

Model	Shaft	Key
V	2306	1612
VK	29707	1609

Included in 912098 seal kit

Model Code

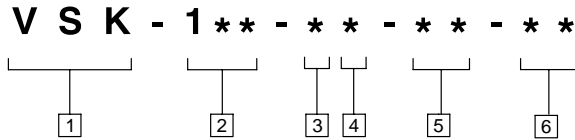

1 Model Series

VSK - Vane pump, straight thread only, motor pump mounting only

2 Mounting

- 108 - Foot
- 109 - Flange
- 110 - None

3 Capacity (Head end pump)

4 Capacity (Shaft end pump)

- A - 5.3 USGPM
- C - 8.2 USGPM
- D - 11.5 USGPM
- E - 2.7 USGPM
- G - 3.7 USGPM
- Y - 1.8 USGPM

5 Design Number

6 Rotation

- LH - Left hand
- Omitted - Right hand

**Cartridge Assembly
View Facing Head End**

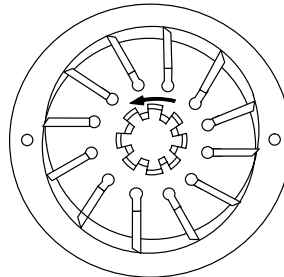

Assembly of the rotor and vanes is determined by the direction of pump shaft rotation. Vanes must be assembled so that the small beveled edges are trailing as shown for right hand rotation. Rotation is determined by viewing pump from shaft end.

For satisfactory service life of these components, use full flow filtration to provide fluid which meets ISO cleanliness code 20/18/15 or cleaner. Selections from Vickers OFP, OFR, and OFRS series are recommended.

Eaton Hydraulics

15151 Highway 5
Eden Prairie, MN 55344
Telephone: 612 937-7254
Fax: 612 937-7130
www.eatonhydraulics.com

46 New Lane, Havant
Hampshire PO9 2NB
England
Telephone: (44) 170-548-6451
Fax: (44) 170-548-7110

