

VLT® Control Panel LCP 23

VLT® AutomationDrive FC 360

1 Introduction and Installation

1.1 Description

This installation guide explains how to install the VLT® Control Panel LCP 23 for VLT® AutomationDrive FC 360.

1.2 Item Supplied

- VLT® Control Panel LCP 23 (code number: 132B0801).

1.3 Safety Precautions

Only qualified personnel are allowed to install the LCP 23 described in this installation guide.

For important information about safety precautions for installation, refer to the drive's operating guide.

⚠ W A R N I N G ⚠

DISCHARGE TIME

The drive contains DC-link capacitors, which can remain charged even when the drive is not powered. High voltage can be present even when the warning indicator lights are off.

Failure to wait the specified time after power has been removed before performing service or repair work could result in death or serious injury.

- Stop the motor.
- Disconnect AC mains, permanent magnet type motors, and remote DC-link supplies, including battery back-ups, UPS, and DC-link connections to other drives.
- Wait for the capacitors to discharge fully. The minimum waiting time is specified in the table *Discharge time* and is also visible on the nameplate on top of the drive.
- Before performing any service or repair work, use an appropriate voltage measuring device to make sure that the capacitors are fully discharged.

Table 1: Discharge Time for FC 360

Voltage [V]	Enclosure size	Power range [kW (hp)]		Minimum waiting time (minutes)
		NO	HO	
3x400	J1, J2, and J3	–	0.37–7.5 (0.5–10)	4
3x400	J4, J5, J6, and J7	11–90 (15–125)	11–75 (15–100)	15
3x400	J8 and J9	110–315 (150–450)	90–250 (125–350)	20

1.4 Mounting the LCP 23

Procedure

1. Position the bottom of LCP 23 in the drive, see [Illustration 1](#).

⚠ C A U T I O N ⚠

When mounting the LCP 23, do not push or press too hard!

- If it is not possible to mount the LCP 23 in one easy operation directly on the drive, try to insert LCP 23 before mounting the terminal cover. When the terminal cover is removed and the drive is powered, do not touch the power terminals.

2. Push the top of LCP 23 into place, see [Illustration 2](#).

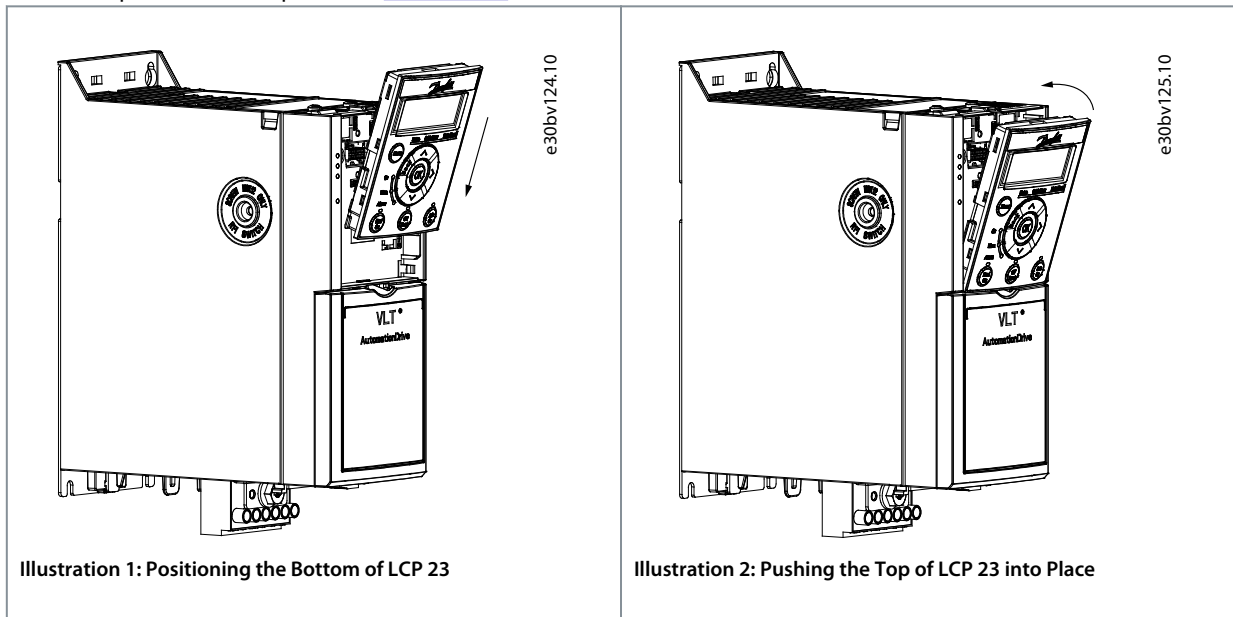

1.5 Dismounting the LCP 23

Procedure

1. Push the top of LCP 23 to the opposite direction of the drive, see [Illustration 3](#).
2. Pull up and take down the LCP 23 from the drive, see [Illustration 4](#).

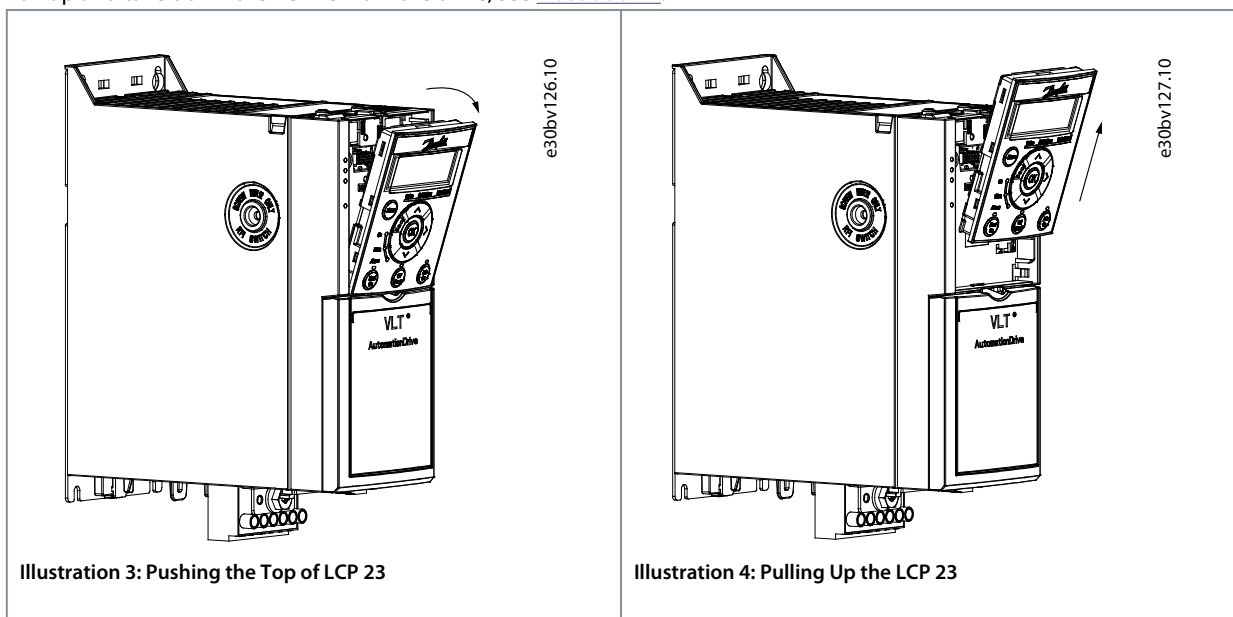

Danfoss A/S
 Ulsnaes 1
 DK-6300 Graasten
vlt-drives.danfoss.com

Danfoss can accept no responsibility for possible errors in catalogs, brochures, and other printed material. Danfoss reserves the right to alter its products without notice. This also applies to products already on order provided that such alterations can be made without consequential changes being necessary in specifications already agreed. All trademarks in this material are property of the respective companies. Danfoss and the Danfoss logotype are trademarks of Danfoss A/S. All rights reserved.

