

Center Lock Unit

Locating pin workpiece contact portion can switch from center lock (for locating) to free (for releasing workpiece)

Even when the workpiece is distorted after welding, if the locating pin is set to free, the workpiece can be removed easily from the locating pin.

■ The locating pin changes to center lock by pressurization of the lock port, and changes to free by pressurization of the lock release port.

■ Center lock positioning accuracy $\pm 0.1 \text{ mm}$
(α direction only)

■ Locating pin swing angle and rotation angle
 $\alpha = 3^\circ \pm 1^\circ$
 $\theta = 3^\circ \pm 1^\circ$

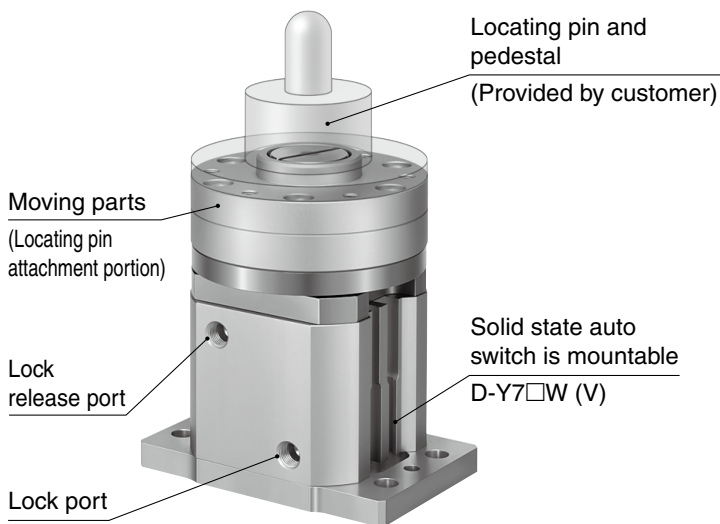

Application Example Used as a pedestal for the locating pin in the welding process

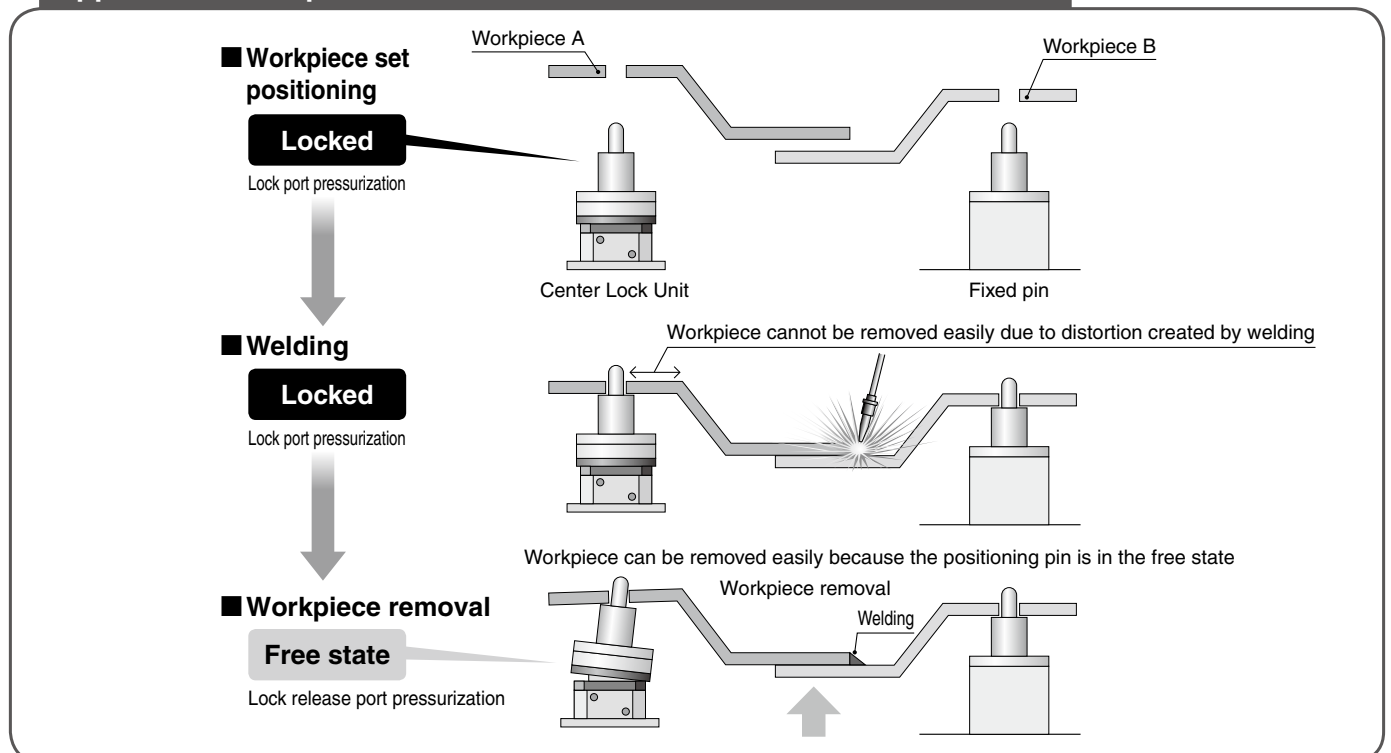

MA331-X441



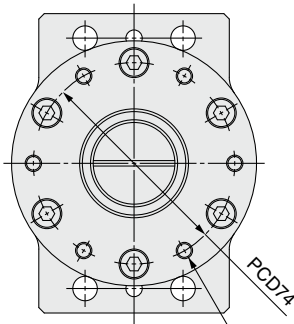
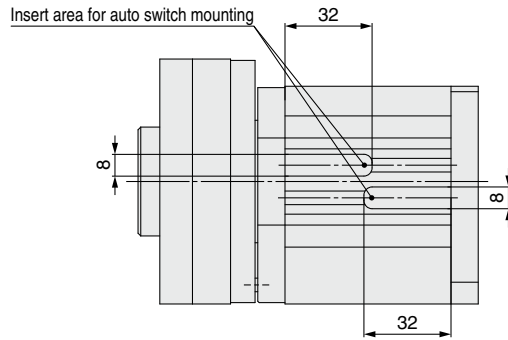

Dimensions

MA331-F4-X441

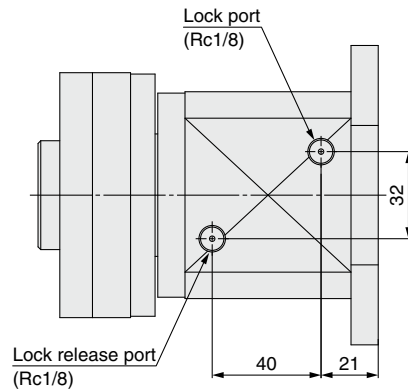
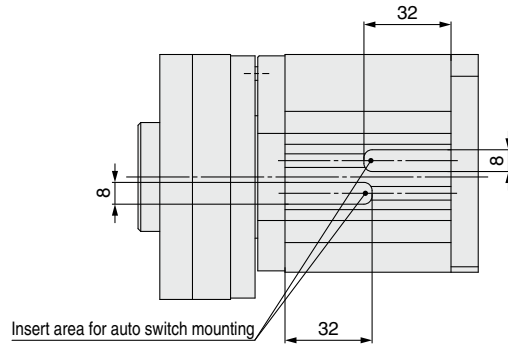
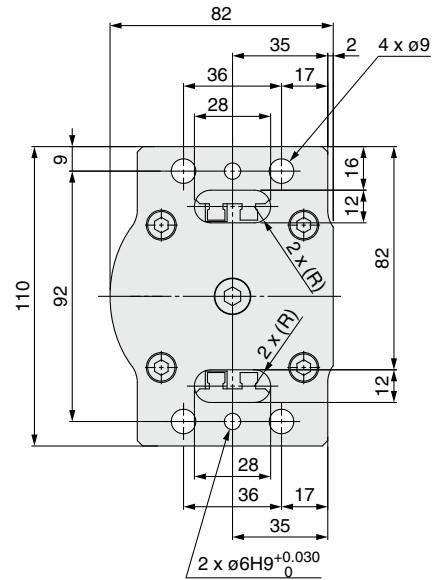

6 x M6 x 1 Thread depth 12
(60° equally spaced)



 **Safety Instructions** Be sure to read the "Handling Precautions for SMC Products" (M-E03-3) and "Operation Manual" before use.