



# The State-of-the-art HMI that adapts to your needs

Introducing Magelis GTU, the high-performance modular HMI panel with unrivalled visualization and control



Vijeo Designer



Vijeo XD



Vijeo Design Air/Air+



Vijeo XL



[www.schneider-electric.com/hmi](http://www.schneider-electric.com/hmi)

Life Is On

**Schneider**  
Electric

# Build the HMI panel

## You have always wanted

The innovative design of Magelis™ GTU from Schneider Electric gives you a unique opportunity to create a state-of-the-art HMI configuration tailored to the specific requirements of your application. Define your preferred combination of panel box and different displays to build your perfect HMI, while keeping the number of references in your inventory to the minimum.

Save time and simplify your daily business by accessing your data anytime from everywhere. Powered by Vijeo™ Designer, Vijeo XD and Vijeo XL on Open Box, Magelis GTU offers outstanding capabilities for remote connectivity and monitoring:

- Mobile access: Vijeo Design'Air/Air+ mobile apps allow remote machine commissioning, as well as real-time monitoring and diagnostics.
- USB accessories: Get a clear view into your operations with a wide range of plug-and-play USB accessories that add functionality and reduce installation cost.

## Automation architectures for machines

Magelis GTU is fully integrated with SoMachine™, a flexible control solution for OEM machine builders. It is a perfect companion to motion applications with Lexium™ or PacDrive™ solutions.

## Automation architectures for factories

Magelis GTU is designed for PlantStruxure™, the collaborative Ethernet-based automation architecture from Schneider Electric, as well as Modicon™ M580, the world's first ePAC (Ethernet PAC), allowing HMI applications to visualize PLCs and drive Web servers, share alarms without additional development, and launch SCADA client applications.

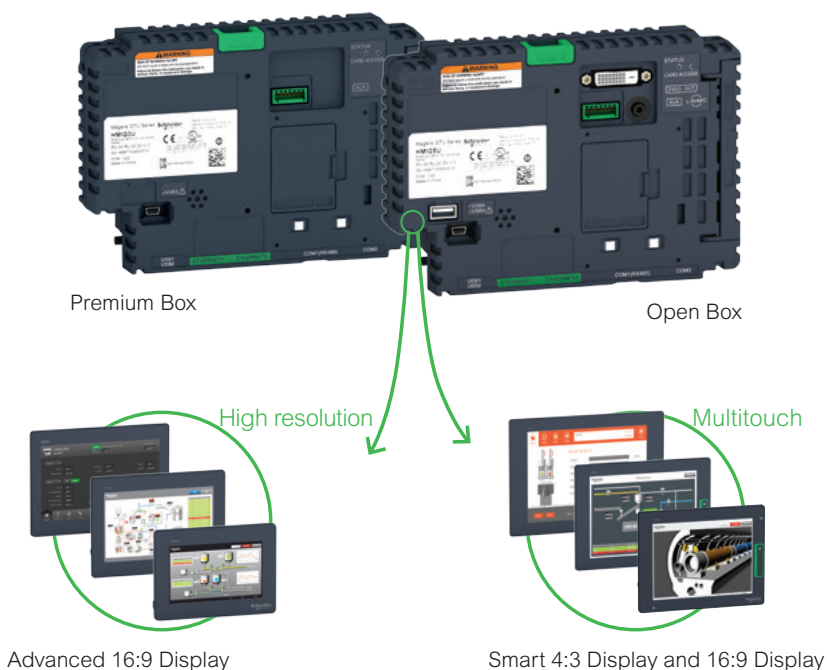

## Magelis GTU

assures flexibility, ease of operation, and openness.

# So many applications

## One flexible HMI

Just combine a panel box with a display of your choice and you have created the ideal HMI for your applications, ready to install on your machine without the need for any special tools or accessories. Your personalized Magelis GTU will provide a wealth of features for robust performance, open connectivity, and secure data flow.

- 3 to 6 USB Host ports to easily connect external devices (memory stick, mouse, keyboard, barcode reader, printer, DVD reader....) and Magelis USB accessories (tower light, illuminated switch, keyboard, biometric switch).
- Enhanced performance and security of data flow with dual LAN to separate IT and PLC communication.
- Open connectivity with 2 serial ports with different signal types, support of all main industrial protocols.
- Easy maintenance through dual removable storage units, one for system and one for user data.
- Improved visibility of alarms with speakers and alarm/buzzer output.
- Reliable communication in complex grounding applications, with isolation on the RJ45-RS485 port.
- Optional Fieldbus connection: Profibus Slave and CANopen Slave.
- Multi Screen capability: DVI output on Open Box allows operators to duplicate the image on a large monitor display, up to WUXGA resolution (1920x1200).

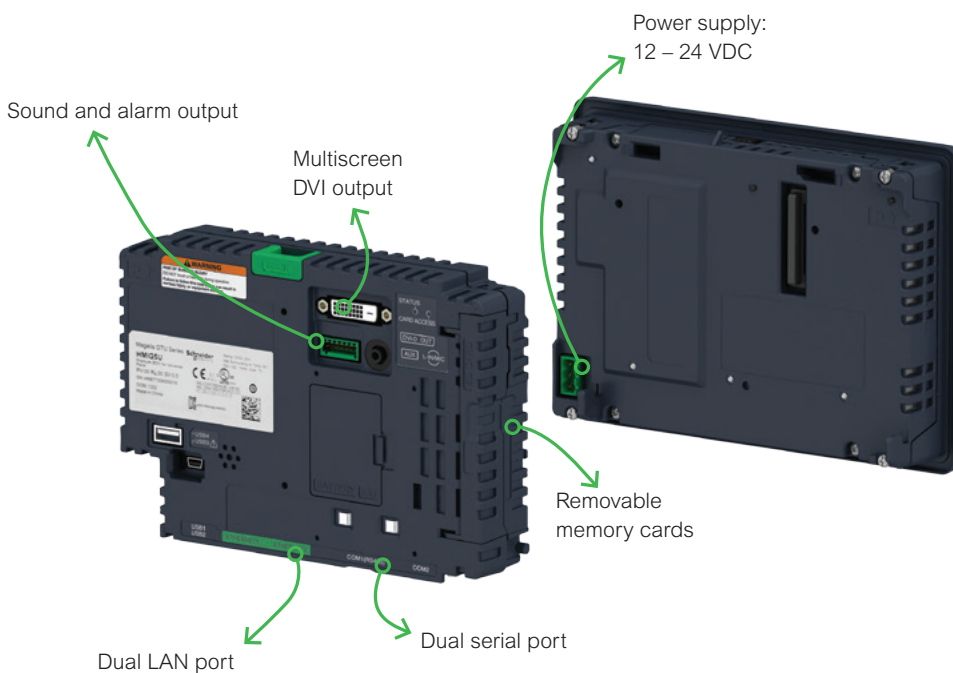

## Magelis GTU

- is suitable for battery-powered applications.
- works in temperature range from 0 °C up to 60 °C.

# Operate intuitively and comfortably

Thanks to the smart-phone like interface

Magelis GTU delivers unmatched ease and comfort of use for the application developer and its operator. The beautiful high-resolution screen provides a crystal-clear view. Operators can access more information and share high definition pictures with external multimedia devices with wider and larger screens. (7"W, 10"W, 12"W, 15"W, 19"W)

## Navigate your HMI like a smartphone

Magelis GTU is as intuitive to use as your tablet or phone thanks to multitouch navigation and Vijeo XD software with easy view of trends and alarms.

Two multitouch technologies on Magelis GTU:

- Projected Capacitive for more reactivity.
- Resistive for touch with gloves or through screen protections.

## High performance screen:

Enhance operational safety with increased visibility thanks to the LED backlight with 50,000 hours of brightness. The Magelis GTU also provides automatic brightness with a built-in sensor and accurate dimming (100 levels) on the smart display so you can save energy and deliver a safe working environment.



## Magelis GTU

is perfect for machines and plants thanks to quick and easy integration to automation architectures.

# Maintain easily

## While saving time and money

Magelis GTU is optimized for Vijeo XD, the latest HMI configuration software from Schneider Electric. It also supports the current Vijeo Designer software. If, in the future, you decide to upgrade to new software, you will be able to do it easily by simply converting and migrating your application from its current software to another.

### Copy data quickly

Thanks to front USB ports with IP 66/67 protection, you can access and copy HMI data conveniently at any moment without opening the cabinet door. If you need to replace the box or SD or CFast card, you can quickly extract data and restart the application. Using Vijeo XD online mode, you can upgrade your application with no down time — just upload the required part of the project without stopping the machine.

### Dual removable storage units

Replace a terminal while retaining data storage cards with application and user information.

### Remote Maintenance Service - Vijeo Connect

Magelis GTU is a direct service enabler and point access to your machine. Vijeo Connect provides a secure way to access existing Schneider Electric tools (for example: Vijeo Designer, Unity, SoMachine™) to program or monitor machines remotely.



Vijeo Connect

If you are currently using **Magelis XBTGT**, you can upgrade easily, as it uses the same type of cutout and the same software.

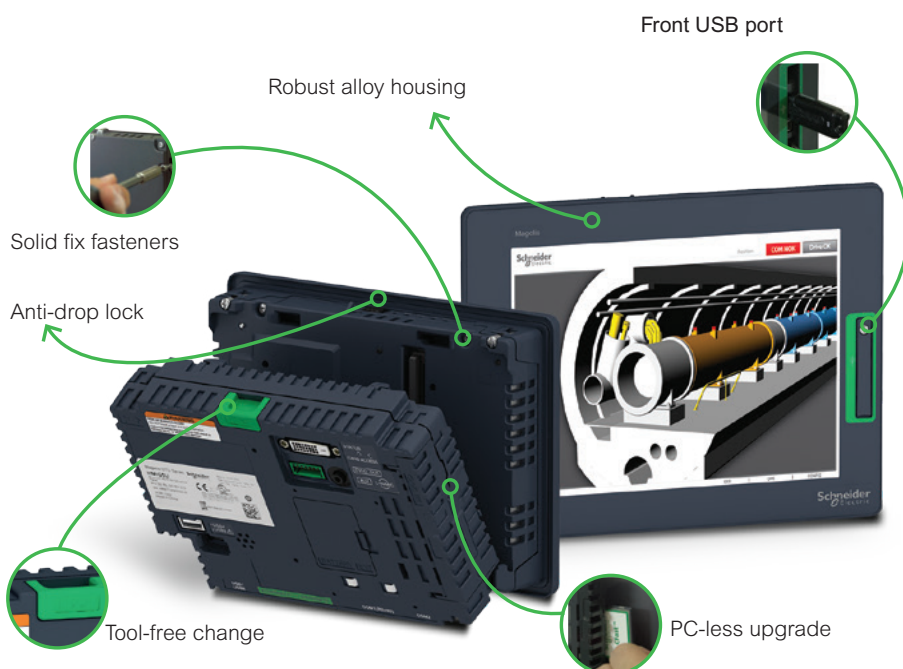

# Ready for IIoT

## With an open HMI

Magelis GTU was designed to offer the flexibility of Microsoft Windows 7 embedded, allowing you to add new functionalities to your HMI application while maintaining the security of your operations.

### Magelis GTU Open Add-on tools preinstalled:



### Simplify maintenance

Build multimedia tutorials using sound and video, view live video from IP and USB cameras, store multi-format documents locally on Cfast or SD cards.

### Access equipment remotely

View all web pages locally or remotely for easy diagnostics and maintenance. Access embedded Web servers of Modicon PLCs, Altivar™ speed drives, Magelis HMI, etc. Get remote access to your PC through VNC.

### Improve security of operations

No data loss with the integrated NVRAM memory in case of shutdown (no need for UPS). Dedicated write-protected CFast card to protect OS and HMI applications from viruses and unauthorized access.

### Manage database with Intelligent Data Service (IDS) add-on of Vijeo Designer or with Vijeo XL Software

Full traceability of operator actions to comply with FDA 21 CFR Part 11 requirement; easy dashboard analysis and report printing. Also, communication to IT level (MES/ERP/Cloud) with standard protocols OPC UA or MQTT.



Vijeo XL

### Magelis GTU is a perfect solution for:



Packaging



Machine tool



F&B



WWW



MMM

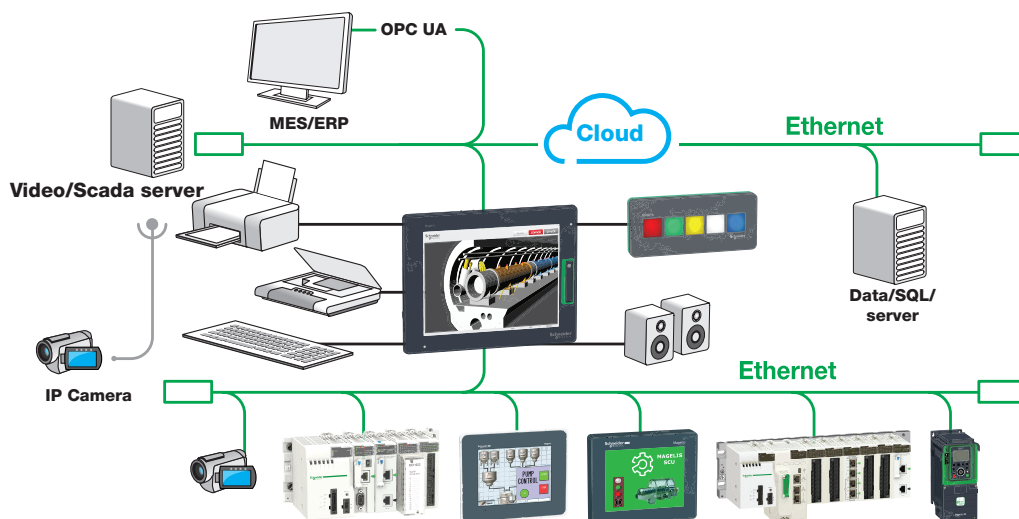

# The future is wireless

## Harness new possibilities

In modern factories, quick access to data is the key to efficiency. It's also the key to meeting the set-up and maintenance requirements of OEMs and end users. The fastest, easiest way to tap into real-time information is via mobile, wireless service devices. Now all it takes to go wireless is one display upgrade. The Magelis GTU W-LAN has everything needed to establish wireless connectivity, including the wireless LAN module and the antenna built into a single housing. Moreover, using the Vijeo Design'Air and Vijeo Design'Air+ apps for smartphones and tablets, you seamlessly connect to the Magelis GTU W-LAN display for machine commissioning as well as real-time monitoring and diagnostics from up to 30 m away. That's how the future looks.

### Flexible\*

- Supports station mode (connection to an existing network) and access point mode (acting as a router in a new network)
- Transparent communication to all devices connected to the two Gigabit Ethernet ports of the processing box
- Also available with conformal coating or as a custom-designed product, without labels or with your company logo and colours

### Reliable

- Resistant to water and dust as per IP67 environmental protection
- Operating temperatures up to 60 °C
- Optional environmental cover adds enhanced resistance against oil and chemicals

### Secure

- State-of-the-art wireless security protocols: WEP/WPA/WPA2
- IEEE 802.11b/g/n compliant
- Radio frequency certifications for Europe, US, Canada, China, Taiwan, South Korea, Japan



\* Depending on the environment, the location to the GTU screen (distance and angle), as well as the application used.

Life Is On

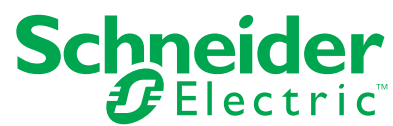

Discover more about Magelis GTU displays and boxes, today!  
[www.schneider-electric.com/hmi](http://www.schneider-electric.com/hmi)

Schneider Electric Industries  
Head Office  
35, rue Joseph Monier - CS 30323  
F92506 Rueil-Malmaison Cedex  
France