

Solderless terminals

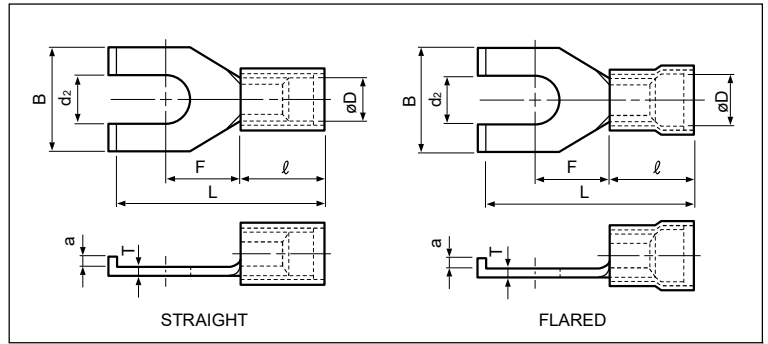

**FLANGED SPADE TONGUE (B type)** Vinyl-insulated with copper sleeve

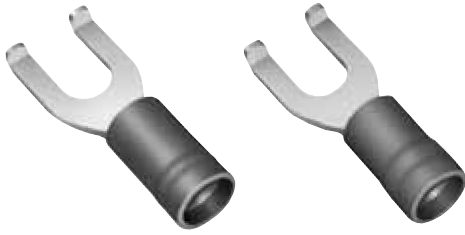
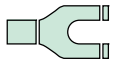

Certificate No.: E42024 LR20812

Applicable Wire AWG#(mm <sup>2</sup> )	Stud size		Part No.		Standard	Dimensions mm (in.)										Color	Tool No.	Qty/box
	American	Metric	Straight	Flared		d <sub>2</sub>	B	L	F	a	ℓ	ø D		T				
26 to 22 (0.2 to 0.5)	1-2	2	VD0.5-2B	—		2.2 (.087)	4.6 (.181)	15.6 (.614)	4.5 (.177)	1.0 (.039)	8.0 (.315)	2.2 (.087)	2.5 (.098)	0.5 (.020)	Yellow	YNT-2622 YA-1 A-2	1,000	
22 to 16 *(0.25 to 1.65)	5-6	3.5	VD1.25-YS3B	—		3.7 (.146)	6.4 (.252)	19.0 (.748)	6.3 (.248)	0.8 (.031)	9.6 (.378)	8.0 (.315)	2.2 (.087)	2.5 (.098)	0.5 (.020)	Red	YNT-2216 YA-1 YA-2 YA-4	1,000
	5-6	3.5	VD1.25-S3B	FVD1.25-S3B		3.7 (.146)	7.5 (.295)	17.9 (.705)	5.1 (.201)	1.5 (.059)								
	5-6	3.5	VD1.25-3B	FVD1.25-3B		3.7 (.146)	8.5 (.335)	22.3 (.878)	7.2 (.283)	0.8 (.031)								
	8	4	VD1.25-YS4B	—		4.3 (.169)	6.4 (.252)	19.0 (.748)	6.3 (.248)	0.8 (.031)								
	8	4	VD1.25-S4B	FVD1.25-S4B		4.3 (.169)	7.5 (.295)	17.9 (.705)	5.1 (.201)	1.5 (.059)								
	8	4	VD1.25-4B	FVD1.25-4B		4.3 (.169)	8.5 (.335)	23.3 (.917)	7.2 (.283)	0.8 (.031)								
	10	5	VD1.25-5B	FVD1.25-5B		5.3 (.209)	8.5 (.335)	23.3 (.917)	7.2 (.283)	1.5 (.059)								
1/4	6	VD1.25-6B	FVD1.25-6B	6.4 (.252)	13.5 (.531)	28.8(1.134)	11.7 (.461)	0.8 (.031)	500									
16 to 14 (1.04 to 2.63)	5-6	3.5	VD2-YS3B	—		3.7 (.146)	6.4 (.252)	19.2 (.756)	6.3 (.248)	0.8 (.031)	9.6 (.378)	8.0 (.315)	2.2 (.087)	2.5 (.098)	0.5 (.020)	Blue	YNT-1614 YA-1 YA-2 YA-4	1,000
	5-6	3.5	VD2-T3B	FVD2-T3B		3.7 (.146)	7.5 (.295)	18.3 (.720)	5.2 (.205)	1.5 (.059)								
	5-6	3.5	VD2-S3B	—		3.7 (.146)	8.5 (.335)	19.6 (.772)	7.2 (.283)	0.8 (.031)								
	5-6	3.5	VD2-3B	FVD2-3B		3.7 (.146)	8.5 (.335)	21.8 (.858)	7.2 (.283)	1.5 (.059)								
	8	4	VD2-T4B	—		4.3 (.169)	7.5 (.295)	18.3 (.720)	5.2 (.205)	0.8 (.031)								
	8	4	VD2-S4B	—		4.3 (.169)	8.5 (.335)	19.6 (.772)	7.2 (.283)	1.5 (.059)								
	8	4	VD2-E4B	—		4.3 (.169)	8.5 (.335)	20.0 (.787)	7.3 (.287)	1.0 (.039)								
	8	4	VD2-4B	FVD2-4B		4.3 (.169)	8.5 (.335)	21.8 (.858)	7.3 (.287)	1.5 (.059)								
10	5	VD2-5B	FVD2-5B	5.3 (.209)	8.5 (.335)	21.8 (.858)	7.3 (.287)	0.8 (.031)	500									
1/4	6	VD2-6B	FVD2-6B	6.4 (.252)	13.5 (.531)	28.8(1.134)	11.7 (.461)	1.0 (.039)	500									
12 to 10 (2.63 to 6.64)	5-6	3.5	VD5.5-S3B	FVD5.5-S3B		3.7 (.146)	7.6 (.299)	25.2 (.992)	6.2 (.244)	1.5 (.059)	14.0 (.551)	5.7 (.224)	6.5 (.256)	1.0 (.039)	Yellow	YNT-1210S YA-4	500	
	5-6	3.5	VD5.5-3B	FVD5.5-3B		3.7 (.146)	8.5 (.335)	26.7(1.051)	7.5 (.295)									
	8	4	VD5.5-S4B	FVD5.5-S4B		4.3 (.169)	7.6 (.299)	25.2 (.992)	6.2 (.244)									
	8	4	VD5.5-4B	—		4.3 (.169)	8.5 (.335)	26.7(1.051)	7.5 (.295)									
	10	5	VD5.5-5B	FVD5.5-5B		5.3 (.209)	8.5 (.335)	26.7(1.051)	7.5 (.295)									
	10	5	VD5.5-E5B	FVD5.5-E5B		5.3 (.209)	9.5 (.374)	24.7 (.972)	7.5 (.295)									
	1/4	6	VD5.5-6B	FVD5.5-6B		6.4 (.252)	13.5 (.531)	33.7(1.367)	12.2 (.480)								1.0 (.039)	250

Note: 1) The part numbers indicated in the above table are for products with a brazed seam.

When ordering products with a butted seam, add the prefix "WS" to the part number (ex. FVD2-4B → FVDWS2-4B).

2) To order products with nylon insulation, change the "V" in the part number prefix to "N" (ex. VD2-4B → ND2-4B).

Because nylon absorbs moisture, care must be taken concerning storage.

3) Delivery lead times may vary depending on the product. Contact JST for details.