

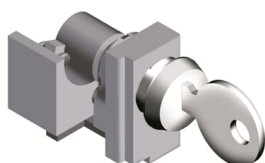

PRODUCT-DETAILS

**KLC T1 KEY LOCK RONIS OP, X C.BREAK.**  
**KLC T1 KEY LOCK RONIS OP, X C.BREAK.**



General Information	
Extended Product Type	KLC T1 KEY LOCK RONIS OP, X C.BREAK.
Product ID	1SDA053528R1
EAN	8015644544768
Catalog Description	KLC T1 KEY LOCK RONIS OP, X C.BREAK.
Long Description	KEY LOCK RONIS 622 IN OPEN WITH KEY WITHDRAWABLE IN OPEN POSITION FOR C.BREAKER T1

Environmental	
Environmental Information	1SDC210015D0201

Ordering	
EAN	8015644544768
Minimum Order Quantity	1 piece
Customs Tariff Number	85389099

---

## Dimensions

---

Product Net Width	150 mm
Product Net Height	25 mm
Product Net Depth / Length	200 mm
Product Net Weight	0.064 kg

---

## Container Information

---

Package Level 1 Units	1 piece
Package Level 1 Gross Weight	0.064 kg
Package Level 1 EAN	8015644544768

---

## Additional Information

---

Product Main Type	Operating Mechanism And Lock
Product Name	Accessory
Suitable For	T1
Suitable for Product Class	SACE Tmax T

---

## Certificates and Declarations

---

Data Sheet, Technical Information	1SDC210015D0201
Declaration of Conformity - CE	Refer to the EU Declaration of the relative Circuit Breaker
Instructions and Manuals	1SDC210015D0201

---

## Classifications

---

Object Classification Code	Q
UNSPSC	39121100
WEEE Category	5. Small Equipment (No External Dimension More Than 50 cm)

---

## Categories

---

Low Voltage Products and Systems → Circuit Breakers → Moulded Case Circuit Breakers → Accessories for Tmax T

