

SCA-2 Connector

LS15 Series
Vertical, T/H, Type
PLUG
1.27mm [.050"] Pitch

SPECIFICATIONS

Mechanical

Contact Retention Force: 250g min.
Mating Force: 100 g max. Per Contact Pair
Unmating Force: 15g min. Per Contact Pair
Durability: 500 Cycles

Electrical

Voltage Rating: 250V
Current Rating: 1.0A .
Contact Resistance: 30mΩ max.
Dielectric Withstanding Voltage: 500V AC
Insulation Resistance: 1000MΩ min.

Physical

Housing: Thermoplastic, UL 94V-0 rated in Black Color
Contact: Phosphor Bronze
Plating: See "ORDERING INFORMATION"
Metal Hold Down: Phosphor Bronze
Operating Temperature: -40 °C to +105 °C

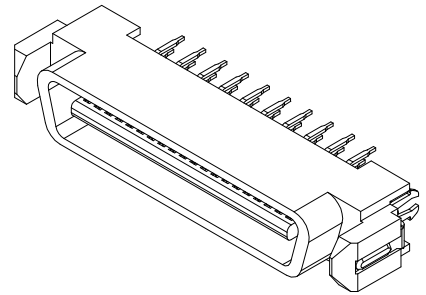

DRAWING

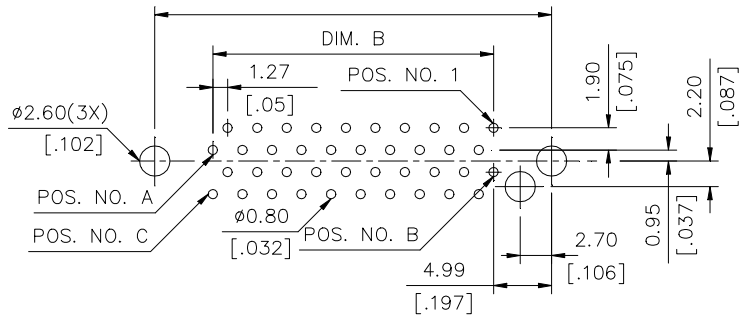
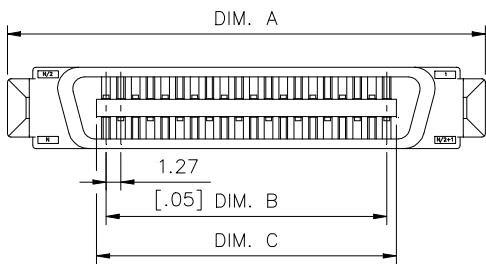

RECOMMENDED PC BOARD

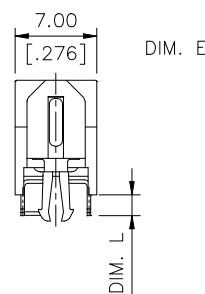
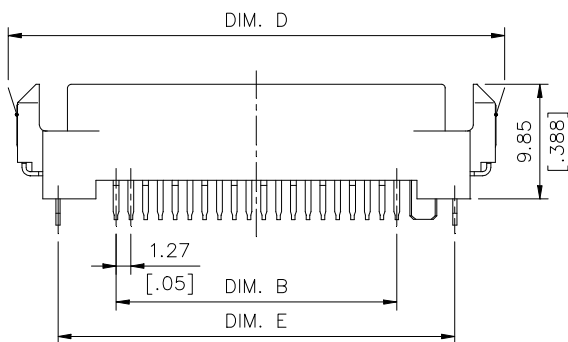

ORDERING INFORMATION

PRODUCT NO.: LS 1 5 * * * - A * 4

- Sca-2
- PLUG
- Mouting End Type
- 5=T/H,Vertical
- No. Of Pos
- 20=40 Pos
- 40=80 Pos
- Mating Area Plating
- 3=30u" Gold
- H=30u" Gold With RoHS Compliance
- Termination Side
- 4=4 Rows
- Tail Length
- 2=2.80 mm
- 3=3.18 mm
- 5=4.57 mm
- 6=3.40 mm
- 9=2.54 mm
- A: Standard Height

LS1540*-A*4	40/80	80	40	41	80	66.40 [2.616]	49.53 [1.951]	51.17 [2.016]	66.50 [2.62]	59.51 [2.345]
LS1520*-A*4	20/40	40	20	21	40	41.00 [1.615]	24.13 [.951]	25.77 [1.015]	41.10 [1.619]	34.11 [1.344]
P/N	POS.	N	A	B	C	DIM. A	DIM. B	DIM. C	DIM. D	DIM. E