

NOTES:

1. DIMENSIONS SHALL BE INTERPRETED PER ASME Y14.5-2009
2. SPECIFICATIONS OF PRODUCT ARE SHOWN ON DRAWING 303-0300-1698
3. MATERIALS OF PARTS ARE SHOWN ON DRAWING 303-0500-1698
4. PRODUCT NO. MATRIX :

LD25 \*\*\* - M \*\*\*

POSITION No.  
 26 = 26 POS.  
 36 = 36 POS.  
 50 = 50 POS.  
 68 = 68 POS.

PACKING TYPE  
 NONE/1 = TRAY(STANDARD TYPE) WITH COVER  
 6 = TAPE&REEL WITH COVER  
 9 = TRAY(NON-STANDARD TYPE) WITH COVER

HOUSING MATERIAL  
 NONE(L) = LCP,COLOR BLACK

MODIFY CODE(1,2,3,4...) SEE TABLE-I

OUTER SHAPE  
 8 = ONE PIECE DESIGN  
 C = WITH STAINLESS SHELL

PLATING CODE

H = 30u" GOLD PLATING WITH RoHS COMPLIANCE  
 V = 15u" GOLD PLATING WITH RoHS COMPLIANCE

DATE CODE: PLEASE REFER TO FOXCONN'S DOC. "SQ-3B0-070".

6. HARMFUL MATERIAL CONTROL PLEASE FOLLOW FOXCONN'S DOC. "EPI12".
7. THE CONCENTRATION OF Br&CL CAN SATISFY THE REQUIREMENTS OF HALOGEN FREE IN DOC. "EPI12"
8. PLEASE CONTACT FOXCONN'S SALES REPRESENTATIVE TO VERIFY PRODUCT DETAILS & AVAILABILITY.

REV.	ECN. No.	APPD.
A	BC06772522	Jake W.Y
B	BC07700795	Yusan
C	BC077026268	Yusan
D	BC077047764	Yusan
E	BC077091363	Yusan
F	BC087035274	Yusan
G	BC087100690	Yusan
H	BC097019934	Yihsin
J	BC110061512	Yihsin
K	BC110095071	Yihsin

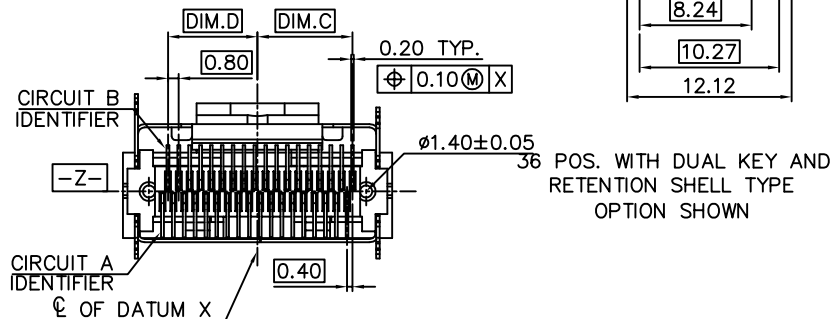
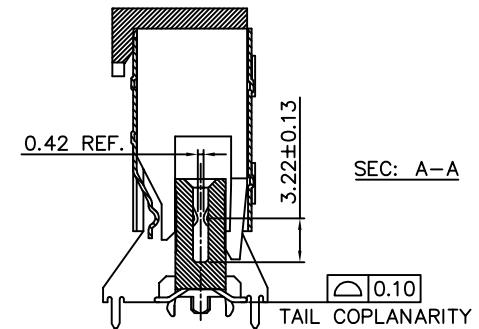
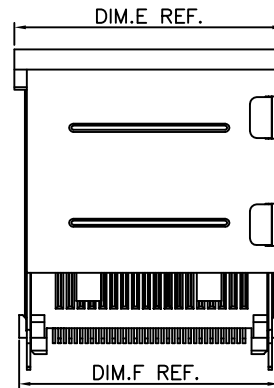
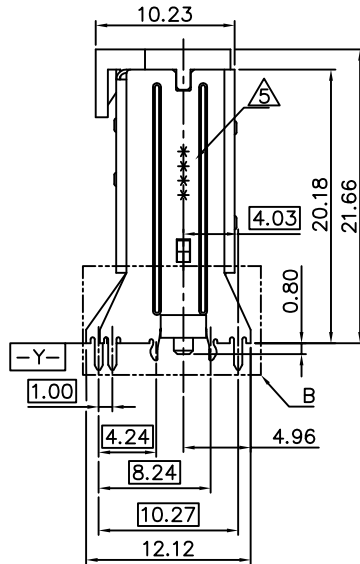
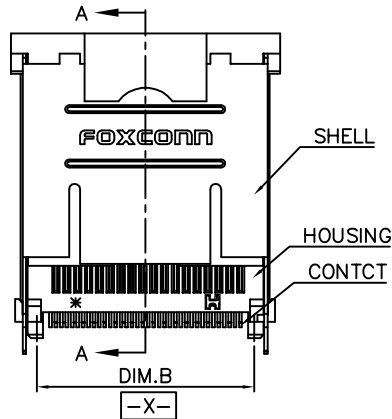
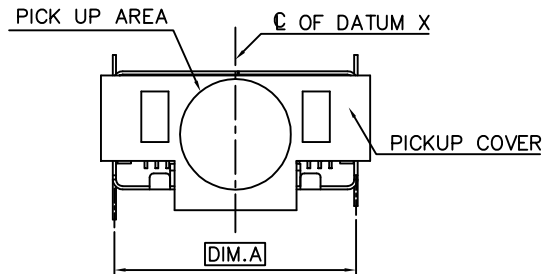

LD2568*-M****	30.60	28.80	13.40	13.00	32.64	31.95	28.40
LD2550*-M****	23.40	21.60	9.80	9.40	25.44	24.75	21.20
LD2536*-M****	17.80	16.00	7.00	6.60	19.84	19.15	15.60
LD2526*-M****	13.80	12.00	5.00	4.60	15.84	15.15	11.60
PRODUCT No.	DIM.A	DIM.B	DIM.C	DIM.D	DIM.E	DIM.F	DIM.G

X±	X'± 1°	UNITS mm	NAME(INTENDED USE)	<b>FOXCONN</b> HON HAI PRECISION IND. CO.,LTD. TAIPEI, TAIWAN, R.O.C.
.X± 0.25	.X'±	MAT'L	MINI SAS	
.XX± 0.13	.XX'±	FINISH	PART NO.(INTENDED USE)	TITLE: CUSTOMER DRAWING VERTICAL,0.8mm PITCH
.XXX±	.XXX'±		LD25***-M****	DWG NO.: 303-0000-1698
THESE DRAWINGS AND SPECIFICATIONS ARE THE PROPERTY OF HON HAI PRECISION IND. CO., LTD. AND SHALL NOT BE REPRODUCED, COPIED OR USED IN ANY MANNER WITHOUT THE PRIOR WRITTEN CONSENT OF HON HAI PRECISION IND. CO., LTD.			APPD: Shih-wei Hsiao	SCALE SHEET REV. N/A 1/7 KX1
			CHKD: Yen-chih.Chang	
			DR Betty Liu 05/05'14	

REV.	ECN.	No.	APPD.

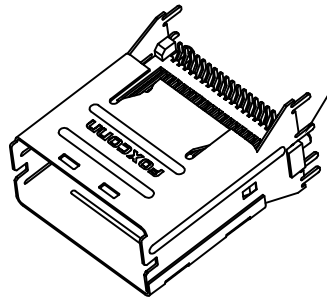

THROUGH PIN

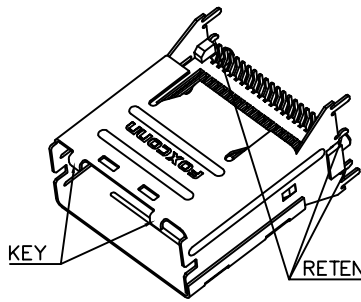
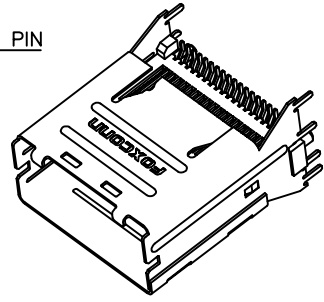

RETENTION PIN

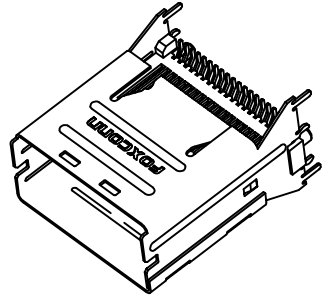

UNIVERSAL AND THROUGH HOLE SHELL  
TYPY I WITHOUT COVER

DUAL KEY AND THROUGH HOLE SHELL  
TYPY II WITHOUT COVER

DUAL KEY AND RETENTION SHELL  
TYPY III WITHOUT COVER

UNIVERSAL AND RETENTION SHELL  
TYPY IV WITHOUT COVER

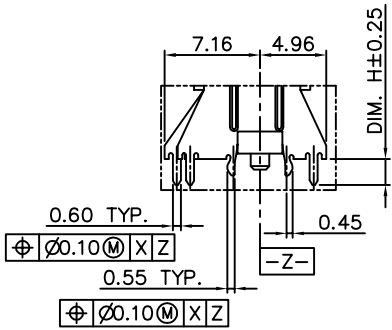

DETAIL B  
FOR RETENTION SHELL TYPE

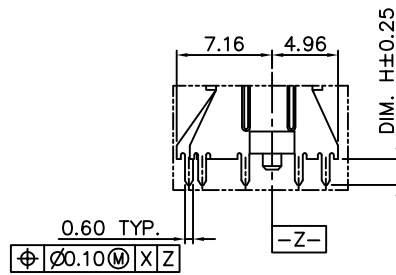

DETAIL B  
FOR THROUGH HOLE SHELL TYPE

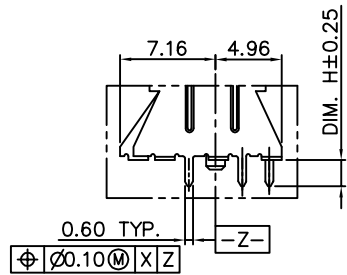

DETAIL B  
FOR SMT SHELL TYPE

X.±	X° ± 1°	UNITS mm	NAME(INTENDED USE)	<b>FOXCONN</b> HON HAI PRECISION IND. CO.,LTD. TAIPEI, TAIWAN, R.O.C.
.X± 0.25	.X°±	MAT'L	MINI SAS	
.XX± 0.13	.XX°±	FINISH	PART NO.(INTENDED USE)	TITLE: CUSTOMER DRAWING
.XXX±	.XXX°±		LD25***-M****	VERTICAL,0.8mm PITCH
THESE DRAWINGS AND SPECIFICATIONS ARE THE PROPERTY OF HON HAI PRECISION IND. CO., LTD. AND SHALL NOT BE REPRODUCED, COPIED OR USED IN ANY MANNER WITHOUT THE PRIOR WRITTEN CONSENT OF HON HAI PRECISION IND. CO., LTD.		Q'TY	APPD: Shih-wei Hsiao	DWG NO:
			CHKD: Yen-chih.Chang	303-0000-1698
			DR Betty Liu 05/05'14	SCALE SHEET REV.
			⊕	N/A 2/7 KX1

REV.	ECN.	No.	APPD.

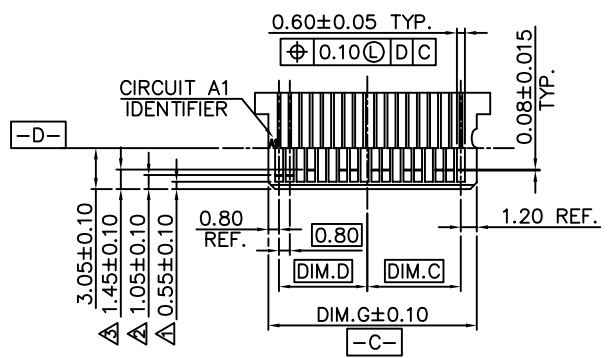

MATING INTERFACE

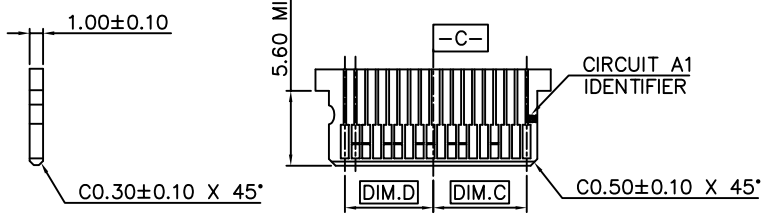

- NOTES:
- BOARD LAYOUT PER DEFINED STANDARD OR CUSTOMER REQUIREMENTS.
  - ① PAD CONFIGURATION FOR THIRD MATE (HIGH SPEED SIGNALS).
  - ② PAD CONFIGURATION FOR SECOND MATE.
  - ③ PAD CONFIGURATION FOR FIRST MATE
  - ④ MINIMUM STEP REQUIRED IF P.C.B. MADE WIDER THAN CARD TOUNGE.

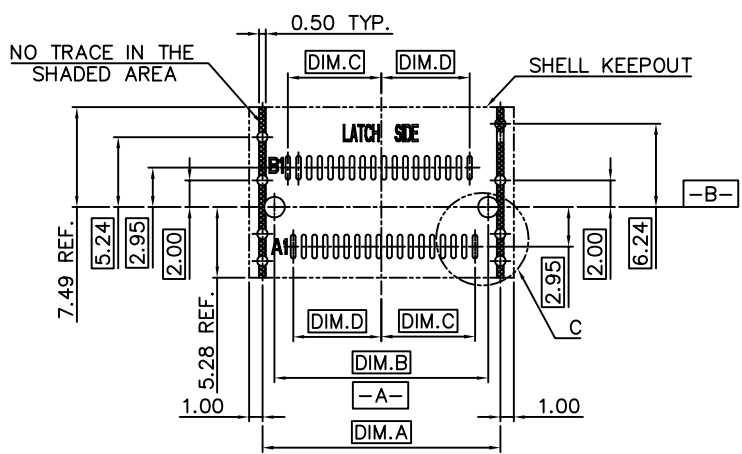

RECOMMENDED P.C.B. LAYOUT FOR THROUGH HOLE SHELL TYPE

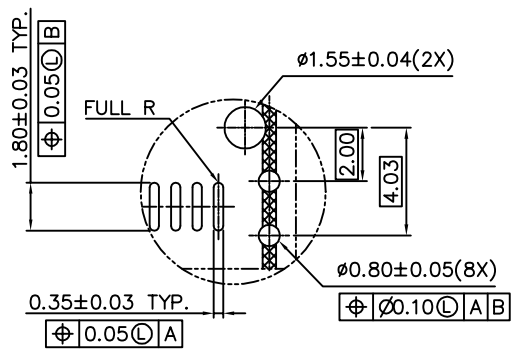

DETAIL C SCALE 2:1

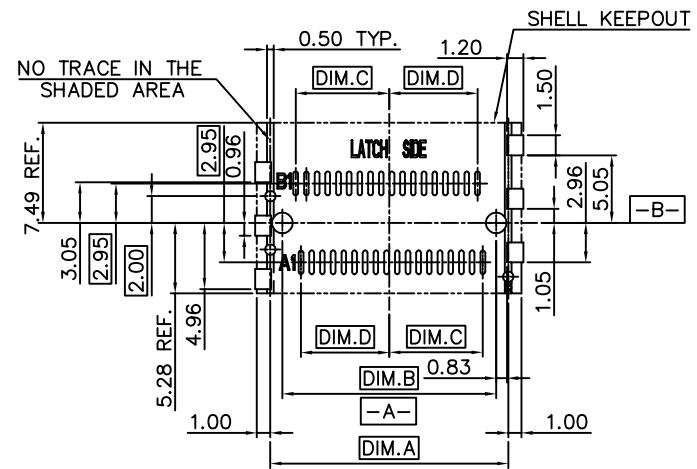

RECOMMENDED P.C.B. LAYOUT FOR SMT SHELL TYPE

x.±	x°.± 1°	UNITS mm	NAME(INTENDED USE)	<b>FOXCONN</b> HON HAI PRECISION IND. CO.,LTD. TAIPEI, TAIWAN, R.O.C.
.x± 0.25	.x°±	MAT'L	MINI SAS	
.xx± 0.13	.xx°±	FINISH	PART NO.(INTENDED USE)	TITLE: CUSTOMER DRAWING
.xxx±	.xxx°±		LD25***-M****	VERTICAL,0.8mm PITCH
THESE DRAWINGS AND SPECIFICATIONS ARE THE PROPERTY OF HON HAI PRECISION IND. CO., LTD. AND SHALL NOT BE REPRODUCED, COPIED OR USED IN ANY MANNER WITHOUT THE PRIOR WRITTEN CONSENT OF HON HAI PRECISION IND. CO., LTD.			APPD: Shih-wei Hsiao	DWG No.: 303-0000-1698
			Q'TY	CHKD: Yen-chih.Chang
			DR Betty Liu 05/05'14	N/A 3/7 KX1

REV.	ECN.	No.	APPD.

LD25***-M*T**	3.56	THROUGH HOLE	UNIVERSAL
LD25***-M*R**	3.56	THROUGH HOLE	RIGHT
LD25***-M*Q**	3.56	THROUGH HOLE	LEFT
LD25***-M*P**	4.50	THROUGH HOLE	UNIVERSAL
LD25***-M*N**	3.18	THROUGH HOLE	DUAL KEY
LD25***-M*M**	3.18	THROUGH HOLE	RIGHT
LD25***-M*L**	3.18	THROUGH HOLE	LEFT
LD25***-M*K**	1.96	THROUGH HOLE	DUAL KEY
LD25***-M*J**	1.96	THROUGH HOLE	RIGHT
LD25***-M*H**	1.96	THROUGH HOLE	LEFT
LD25***-M*G**	1.96	RETENTION	UNIVERSAL
LD25***-M*F**	1.96	RETENTION	RIGHT
LD25***-M*E**	1.96	RETENTION	LEFT
LD25***-M*D**	1.96	SMT	UNIVERSAL
LD25***-M*C**	1.96	SMT	DUAL KEY
LD25***-M*B**	1.96	SMT	RIGHT
LD25***-M*A**	1.96	SMT	LEFT
LD25***-M*9**	2.79	THROUGH HOLE	LEFT
LD25***-M*8**	2.79	THROUGH HOLE	RIGHT
LD25***-M*7**	2.79	THROUGH HOLE	DUAL KEY
LD25***-M*6**	2.79	RETENTION	UNIVERSAL
LD25***-M*5**	2.79	THROUGH HOLE	UNIVERSAL
LD25***-M*4**	3.56	THROUGH HOLE	DUAL KEY
LD25***-M*3**	1.96	RETENTION	DUAL KEY
LD25***-M*2**	3.18	THROUGH HOLE	UNIVERSAL
LD25***-M*1**	1.96	THROUGH HOLE	UNIVERSAL
P/N DIM.H SHELL P.C.B. OPTION SHELL KEY OPTION			

TABLE-I

X.±	X'.± 1°	UNITS mm	NAME(INTENDED USE)	<b>FOXCONN</b>			
.x± 0.25	.x'±	MAT'L	MINI SAS	HON HAI PRECISION IND. CO.,LTD. TAIPEI, TAIWAN, R.O.C.			
.xx± 0.13	.xx'±		PART NO.(INTENDED USE)	TITLE: CUSTOMER DRAWING			
.xxx±	.xxx'±	FINISH	LD25***-M****	VERTICAL,0.8mm PITCH			
THESE DRAWINGS AND SPECIFICATIONS ARE THE PROPERTY OF HON HAI PRECISION IND. CO., LTD. AND SHALL NOT BE REPRODUCED COPIED OR USED IN ANY MANNER WITHOUT THE PRIOR WRITTEN CONSENT OF HON HAI PRECISION IND. CO., LTD.			APPD:	DWG No.:			
			Q'TY	Shih-wei Hsiao	303-0000-1698		
			CHKD:				
			Yen-chih.Chang				
			DR: Betty Liu 05/05'14		SCALE	SHEET	REV.
				N/A	4/7	KX1	

REV.	ECN.	NO.	APPD.

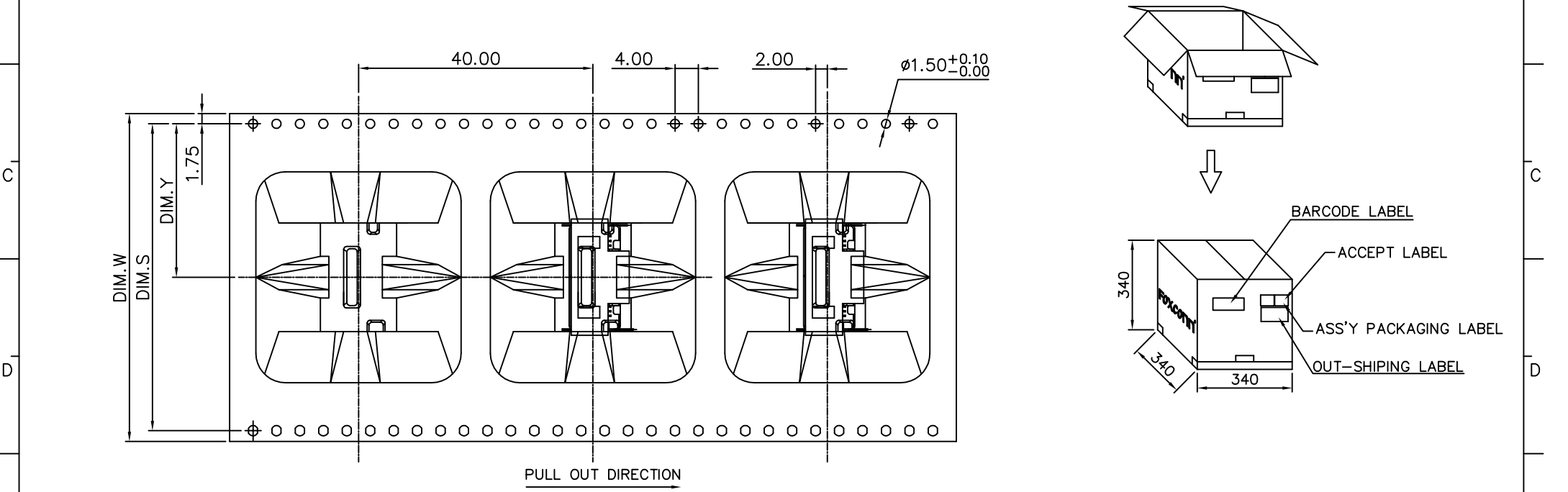
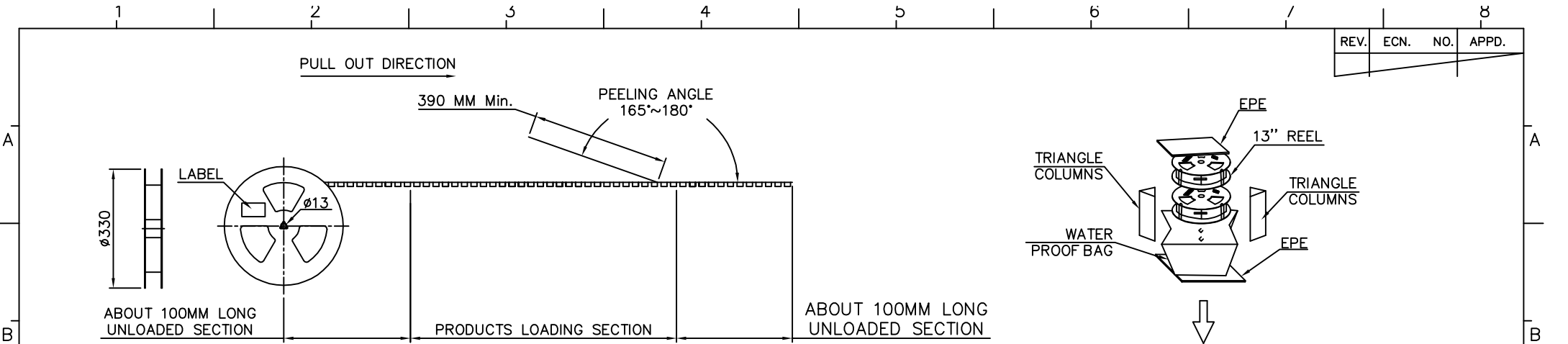

LD2568*-M**L6	72.00	68.40	34.20
LD2550*-M**L6	56.00	52.40	26.20
LD2536*-M**L6	56.00	52.40	26.20
LD2526*-M**L6	44.00	40.40	20.20
PRODUCT No.	DIM.W	DIM.S	DIM.Y

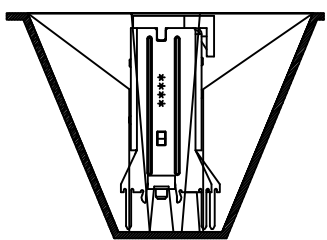

X.±	X° ± 1°	UNITS	mm	NAME(INTENDED USE)	<b>FOXCONN</b> HON HAI PRECISION IND. CO.,LTD. TAIPEI, TAIWAN, R.O.C.
.X± 0.25	.X°±	MAT'L		MINI SAS	
.XX± 0.13	.XX°±			PART NO.(INTENDED USE)	TITLE: CUSTOMER DRAWING
.XXX±	.XXX°±	FINISH		LD25***-M****	VERTICAL,0.8mm PITCH
THESE DRAWINGS AND SPECIFICATIONS ARE THE PROPERTY OF HON HAI PRECISION IND. CO., LTD. AND SHALL NOT BE REPRODUCED, COPIED OR USED IN ANY MANNER WITHOUT THE PRIOR WRITTEN CONSENT OF HON HAI PRECISION IND. CO., LTD.				APPD:	DWG NO.:
		Q'TY		Shih-wei Hsiao	303-0000-1698
				CHKD: Yen-chih.Chang	
				DR: Betty Liu 05/05'14	
					SCALE SHEET REV.
					N/A 5/7 KX1

REV.	ECN.	No.	APPD.

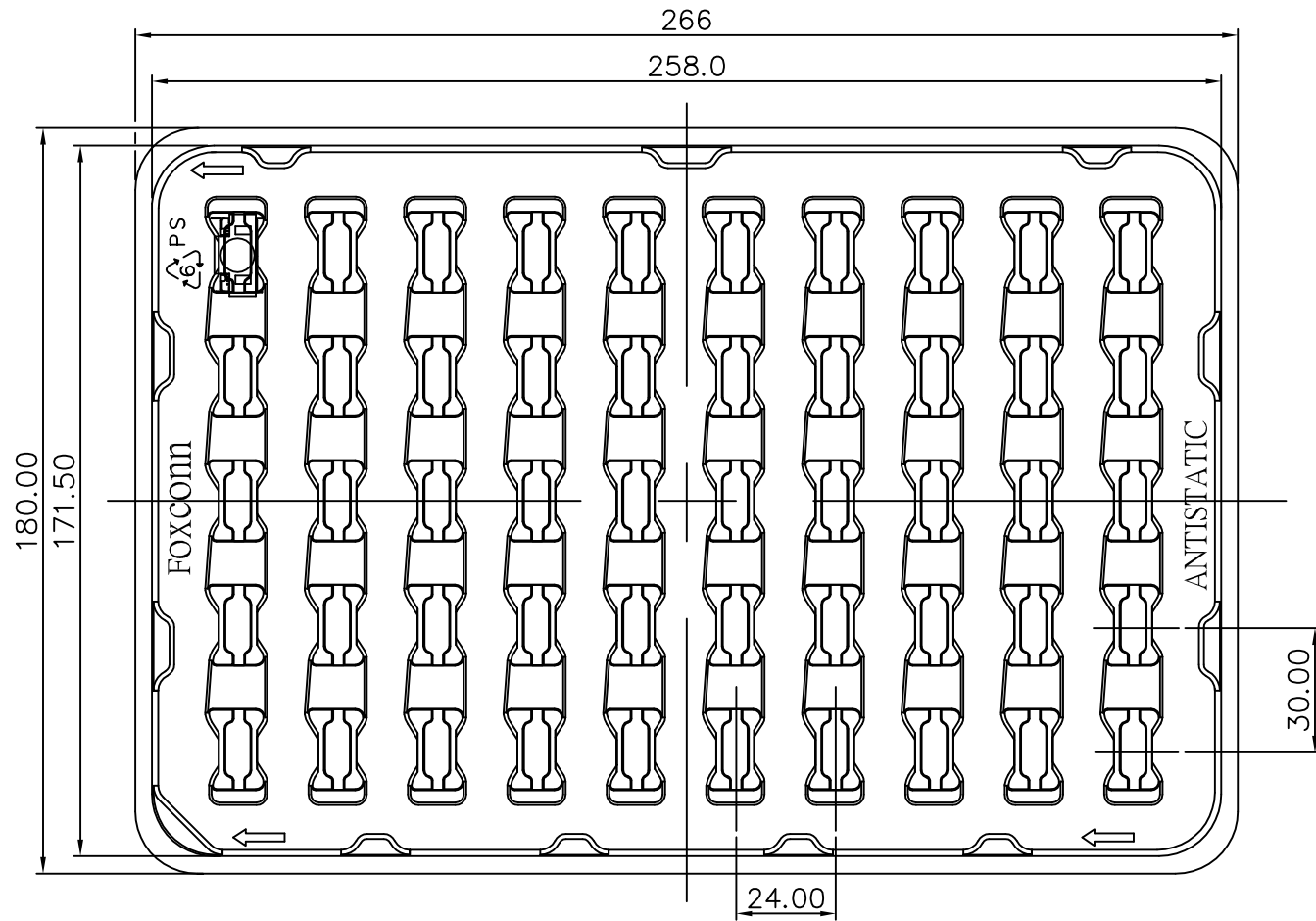

STANDARD TRAY FOR 36PINS

X.±	X'± 1°	UNITS mm	NAME(INTENDED USE)	<b>FOXCONN</b> HON HAI PRECISION IND. CO.,LTD. TAIPEI, TAIWAN, R.O.C.						
.X± 0.25	.X'±	MAT'L	MINI SAS							
.XX± 0.13	.XX'±	FINISH	PART NO.(INTENDED USE)	TITLE: CUSTOMER DRAWING						
.XXX±	.XXX'±		LD25***-M****	VERTICAL,0.8mm PITCH						
THESE DRAWINGS AND SPECIFICATIONS ARE THE PROPERTY OF HON HAI PRECISION IND. CO., LTD. AND SHALL NOT BE REPRODUCED, COPIED OR USED IN ANY MANNER WITHOUT THE PRIOR WRITTEN CONSENT OF HON HAI PRECISION IND. CO., LTD.			APPD:	DWG No.:						
			Shih-wei Hsiao	303-0000-1698						
			CHKD: Yen-chih.Chang							
			DR: Betty Liu 05/05'14	<table border="1"> <tr> <td>SCALE</td> <td>SHEET</td> <td>REV.</td> </tr> <tr> <td>N/A</td> <td>6/7</td> <td>KX1</td> </tr> </table>	SCALE	SHEET	REV.	N/A	6/7	KX1
SCALE	SHEET	REV.								
N/A	6/7	KX1								

REV.	ECN.	No.	APPD.

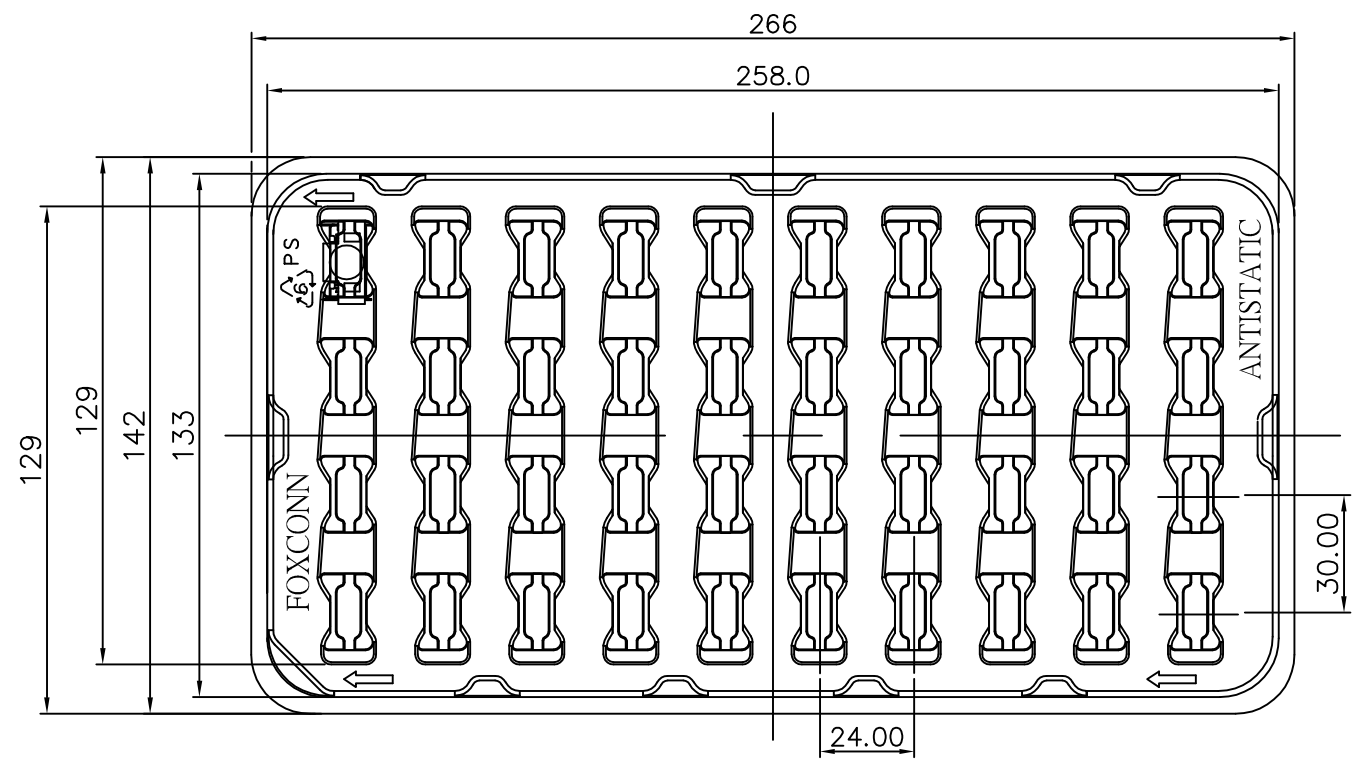

NON-STANDARD TRAY FOR 36PINS

X.±	X.° ± 1°	UNITS mm	NAME(INTENDED USE)	<b>FOXCONN</b>						
.X± 0.25	.X°±	MAT'L	MINI SAS	HON HAI PRECISION IND. CO.,LTD. TAIPEI, TAIWAN, R.O.C.						
.XX± 0.13	.XX°±	FINISH	PART NO.(INTENDED USE)	TITLE: CUSTOMER DRAWING VERTICAL,0.8mm PITCH						
.XXX±	.XXX°±		LD25***-M****	DWG No.: 303-0000-1698						
<small>THESE DRAWINGS AND SPECIFICATIONS ARE THE PROPERTY OF HON HAI PRECISION IND. CO., LTD. AND SHALL NOT BE REPRODUCED COPIED OR USED IN ANY MANNER WITHOUT THE PRIOR WRITTEN CONSENT OF HON HAI PRECISION IND. CO., LTD.</small>			APPD: Shih-wei Hsiao	<table border="1"> <tr> <td>SCALE</td> <td>SHEET</td> <td>REV.</td> </tr> <tr> <td>N/A</td> <td>7/7</td> <td>KX1</td> </tr> </table>	SCALE	SHEET	REV.	N/A	7/7	KX1
			SCALE		SHEET	REV.				
			N/A	7/7	KX1					
Q'TY	CHKD: Yen-chih.Chang	DR: Betty Liu 05/05'14								

# SPECIFICATIONS :

## 1. MATERIAL AND FINISH :

### 1-1. HOUSING :

HIGH TEMPERATURE, THERMOPLASTIC , UL94 V-0 , COLOR BLACK.

### 1-2. CONTACT :

COPPER ALLOY, NICKEL PLATING OVER ALL, THICKNESS 50u" MIN.,  
TIN PLATING ON SOLDER AREA, THICKNESS 100u" MIN.,  
GOLD PLATING OVER NICKEL ON CONTACT AREA,

### 1-3. SHELL :

NICKEL SILVER FOR LD25\*\*\*-M8\*\*\*  
STAINLESS STEEL FOR LD25\*\*\*-MC\*\*\* , SOLDERABLE NICKEL PLATING  
THICKNESS 70u" MIN

### 1-4. HARMFUL MATERIAL CONTROL PLEASE FOLLOW DOC. NO. "EPI12"

## 2. ELECTRICAL :

2-1. CURRENT RATING : 0.5 AMPERES PER CONTACT (MAXIMUM)

2-2. CONTACT RESISTANCE: 30 MILLIOHMS (MAXIMUM) PER CONTACT.  
50 MILLIOHMS (MAXIMUM) AFTER TEST.

2-3. INSULATION RESISTANCE : 1000 MEGAOHMS (MINIMUM).

2-4. DIELECTRIC WITHSTANDING VOLTAGE : 300 VAC (MINIMUM) AT SEA LEVEL.

2-5. OPERATING TEMPERATURE : -55°C TO 105° .

## 3. MECHANICAL:

3-1. DURABILITY: 250 CYCLES

3-2. MATING FORCE : 55.5N Max

3-3. UNMATING FORCE : 49.0N Min

3-4. RETENTION FORCE OF CONTACT: 0.200 Kgf/MIN PER PIN.

## 4. ENVIRONMENTAL:

4-1. VIBRATION, RANDOM : PASS EIA-364-28, TEST CONDITION VII, CONDITION D.

4-2. PHYSICAL SHOCK : EIA 364-27, METHOD H.

4-3 THERMAL SHOCK : EIA 364-32C, CONDITION I.

4-4. TEMPERATURE LIFE : PASS EIA-364-17, METHOD A, TEST CONDITION 2,  
TEST TIME CONDITION C.

4-5. HUMIDITY TEMPERATURE CYCLING : PASS EIA-364-31, METHOD III.

4-6. MIXED FLOWING GAS : PASS EIA-364-65, CLASS IIA

4-7. MIXED FLOWING GAS : PASS EIA-364-65, CLASS IIA

4-8. THE PRODUCT IS NOT SUITABLE FOR REFLOW IN AIR

4-9. SOLDERABILITY: PASS MIL-STD-202F ,METHOD 208.

**FOXCONN** HON HAI PRECISION IND. CO.,LTD.  
TAIPEI, TAIWAN, R.O.C.

C	BC-12-0049304	Shih-wei Hsiao
B	BC077026270	Jake.W.Y
A	BC06772523	Jake.W.Y
REV.	ECN NO	APPD.

APPD. : Shih-wei Hsiao	TITLE : SPECIFICATION MINI SAS, RECEPTACLE
CHKD. : Yusan Hsiao	PROD. SERIES: LD25***-M****
DR. : Lisa Wang 05/08'13	DWG. NO : 303-0300-1698
	REV. : CX2 SHEET : 1/1



ITEM	DESC.	Q'TY	MATERIAL	TREATMENT	REMARK
1	HOUSING	1	HIGH TEMP. THERMO -PLASTIC,UL 94V-0	MOLDED BLACK	
2	COVER	1	HIGH TEMP. THERMO -PLASTIC,UL 94V-0	MOLDED BLACK	
3	CONTACT	SEE NOTE BELOW	COPPER ALLOY	A) NICKEL PLATING OVER ALL THICKNESS : 50u"MIN. B) TIN PLATING OVER NICKEL.THICKNESS : 100u"MIN. ON SOLDER AREA C) GOLD FLASH PLATING ON CONTACT AREA	
4	SHELL	1	COPPER ALLOY		
			STAINLESS STEEL	SOLDERABLE NICKEL PLATING THICKNESS 70u" MIN.	

NOTE :

- HARMFUL MATERIAL CONTROL PLEASE FOLLOW DOC NO."EPI12"
- PRODUCT NO. MATRIX:

LD 2 5 \*\* \* - M \* \* \* \*

POSTION No. —

26 = 26 POS.

36 = 36 POS.

50 = 50 POS.

68 = 68 POS.

PLATING CODE —

F = GOLD FLASH PLATING  
WITH RoHS COMPLIANCE

H = 30u" GOLD PLATING  
WITH RoHS COMPLIANCE

V = 15u" GOLD PLATING  
WITH RoHS COMPLIANCE

PACKAGE TYPE:

NONE/1 = TRAY(STANDARD TYPE)  
WITH COVER

6 = TAPE&REEL WITH COVER

9 = TRAY(NON-STANDARD TYPE)  
WITH COVER

HOUSING MATERIAL

NONE(L) : LCP,COLOR BLACK

MODIFICATION CODE

(1,2,3,4,...)

OUTER SHAPE

8 = ONE PIECE DESIGN

C = WITH STAINLESS SHELL

MINI SAS TYPE

**FOXCONN** HON HAI PRECISION IND. CO.,LTD.  
TAIPEI, TAIWAN, R.O.C.

APPD. : Wolfe Liu

TITLE : MATERIAL SHEET  
MINI SAS,RECEPTACLE

CHKD. : Wolfe Liu

PROD. SERIES: LD25\*\*\*-M\*\*\*\*

DR. :  
Tim Zeng 6/7'11

DWG. NO : 303-0500-1698

C	BC110061520	Wolfe Liu
B	BC087026367	Yusan
A	BC06772524	Jake.W.Y
REV.	ECN NO	APPD.

REV. : CX1 SHEET : 1/1