

REV.	ECN.	NO.	APPD.
A	BC05712631		Wen-Guey Lii
B	BC05723119		Wen-Guey Lii

NOTES:

- ELECTRICAL CHARACTERISTICS:
  - CURRENT RATING: 1AMPS ,30° C RISE ABOVE AMBIENT.
  - CONTACT RESISTANCE: 30 MILLIOHMS MAX. INITIAL.  
40 MILLIOHMS MAX. AFTER TEST.
  - PIN TO PIN INSULATION RESISTANCE: 1000 MEGAOHMS MIN.
  - DIELECTRIC WITHSTAND VOLTAGE: 500VAC RMS. MIN. AT SEA LEVEL.
- MECHANICAL CHARACTERISTICS:
  - CONTACT INSERTION FORCE: 170gf MAX. PER CONTACT PAIR.  
USE 1.77[.070] THICKNESS GAUGE.
  - DURABILITY: 100 MATING AND UNMATING CYCLES MIN.
  - CONTACT RETENTION FORCE: 0.45Kgf MIN.
- ENVIRONMENTAL CHARACTERISTICS:
  - OPERATION TEMPERATURE RANGE : -40°C TO +105°C.
- RECOMMENDED PCB THICKNESS: 1.57±0.13[.062±.005].

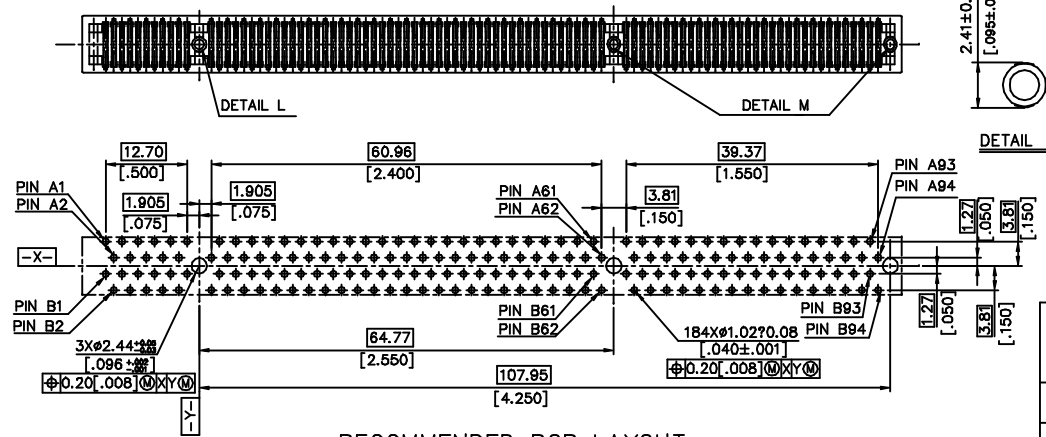
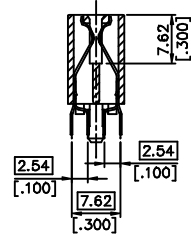
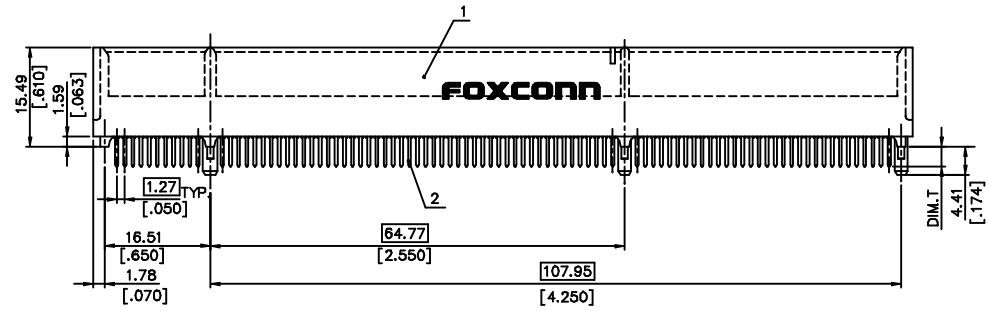
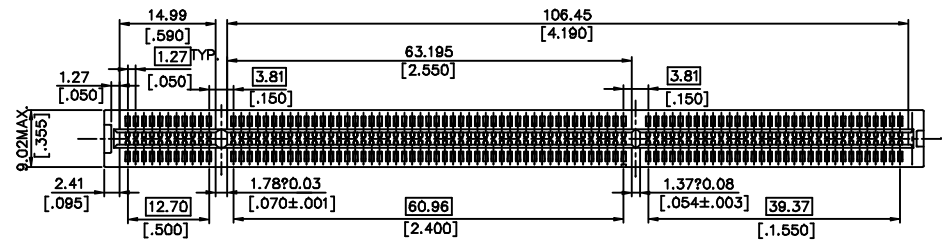

EH 0 92 \* \* - D C W - \*\*

SERIES PREFIX : 1.27[.050] PITCH EDGE CARD CONN.

TERMINATION TYPE: 0: STRAIGHT

NO OF POS.: 92: 92/184 POS.

TAIL LENGTH TYPE: 0: 3.18[.125], 1: 2.54[.100], 4: 3.56[.140]

PLATING TYPE: DN: TIN/LEAD, DF: LEAD FREE

EXTENSION CODE

CONTACT AREA PLATING: 1: GOLD FLASH, 3: 30u" GOLD, 7: 15u" GOLD

2	CONTACT	184	COPPER ALLOY	NICKEL PLATING OVERALL . TIN OR TIN/LEAD PLATING OVER NICKEL AT TAIL . GOLD PLATING ON CONTACT AREA.
1	HOUSING	1	THERMOPLASTIC ,UL94V-0	MOLDED WHITE
ITEM	DESCRIPTION	Q'TY	MATERIAL	TREATMENT
X. ±	X° ± 2°	UNITS	mm [INCH]	NAME<INTENDED USE>
.X ± 0.38 [0.15]	.X° ± 1°	MAT'L	N/A	CUSTOMER
.XX ± [0.10]	.XX° ±	FINISH	N/A	PART NO.<INTENDED USE>
.XXX ±	.XXX° ±	Q'TY	N/A	EH092** - DCW - **
THESE DRAWINGS AND SPECIFICATIONS ARE THE PROPERTY OF HON HAI PRECISION IND. CO., LTD. AND SHALL NOT BE REPRODUCED, COPIED OR USED IN ANY MANNER WITHOUT THE PRIOR WRITTEN CONSENT OF HON HAI PRECISION IND. CO., LTD.				APPD: Wen-Guey Lii 6/30'05
				CHKD: Tin-Suen Liu 6/30'05
				DR: X.H SHEN 6/30'05
				TITLE: 92/184POS.,3.3V PCI CONN.
				DWG NO.: 303-0000-1298
				SCALE SHEET REV. N/A 1/2 B

EH0924* - DCW - **	3.56[.140]
EH0921* - DCW - **	2.54[.100]
EH0920* - DCW - **	3.18[.125]
P/N	DIM.T

REV.	ECN.	NO.	APPD.

SEE SHEET 1/2

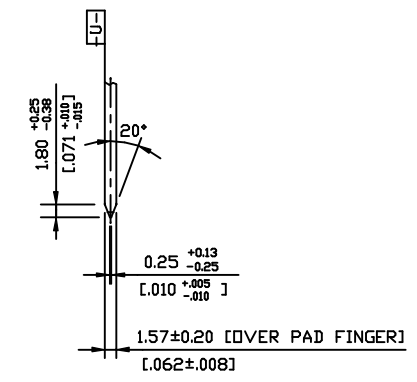
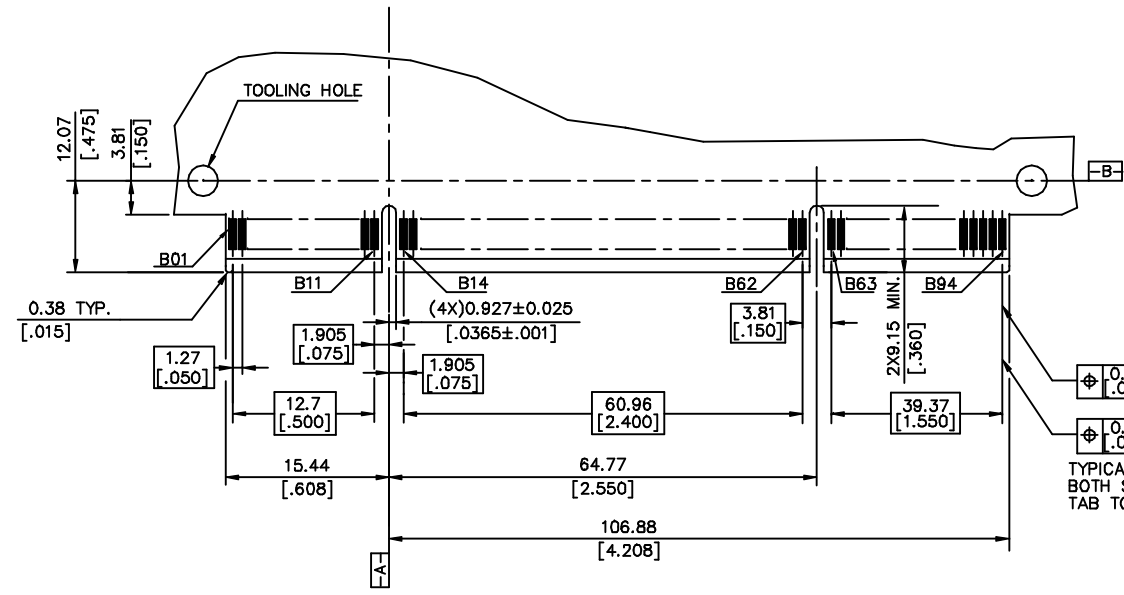
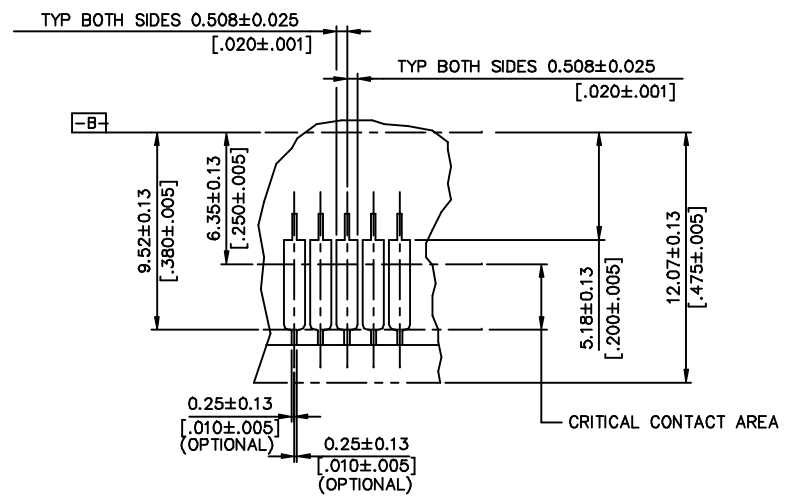

TYPICAL ALL TABS BOTH SIDES TAB TO TAB  
 $\phi 0.05 \pm 0.002$   
 TYPICAL ALL TABS BOTH SIDES TAB TO DATUM  
 $\phi 0.05 \pm 0.002$

X. ±	X° ± 2°	UNITS [mm] [INCH]	NAME (INTENDED USE)	<b>FOXCONN</b> HON HAI PRECISION IND. CO., LTD. TAIPEI, TAIWAN, R.O.C.
.X ± 0.25 [.010]	.X° ±	MAT'L	CUSTOMER	
.XX ± 0.13 [.005]	.XX° ±	N/A	PART NO. (INTENDED USE)	TITLE:
.XXX ±	.XXX° ±	FINISH	EH092** - DCW - **	92/184POS., 3.3V PCI CONN.
THESE DRAWINGS AND SPECIFICATIONS ARE THE PROPERTY OF HON HAI PRECISION IND. CO., LTD. AND SHALL NOT BE REPRODUCED, COPIED OR USED IN ANY MANNER WITHOUT THE PRIOR WRITTEN CONSENT OF HON HAI PRECISION IND. CO., LTD.			APPD: Wen-Guey Lii 6/30'05	DWG NO: 303-0000-1298
			CHKD: Tin-Suen Liu 6/30'05	SCALE SHEET REV.
			DR: X.H SHEN 6/30'05	N/A 2/2 B